

KELLETT SCHOOL



KELLETT SCHOOL

**The Need for
an Independent British Primary School
in Hong Kong**

Kellett School is the only private British primary school in Hong Kong. It is run by the Kellett School Association Limited, a non-profit-making Company. It is being registered as a charity.

At present, Kellett School is in temporary premises at Taikoo Shing.

It was established in January, 1978 and now provides an education for 150 children between the ages of four and seven. By 1982 it will provide for children from four to eleven: one pre-school year, then Primary I to Primary VI.

The purpose of this document is to tell you about the need for Kellett School to expand, to impress upon the business community of Hong Kong the importance of Kellett School to English-speaking families, and thus to obtain the financial support necessary to undertake the ambitious schemes planned to create a unique educational environment in Hong Kong.

The Kellett School Concept

1. Small classes, individual attention. Typical class sizes of twenty.
2. A continuous education from the age of four.
3. Fully qualified teachers. Additional specialist teachers for art, music and physical education give an overall 12:1 pupil to teacher ratio.
4. Progressive British teaching methods; and the latest facilities and equipment.
5. Independence. Kellett School has no connection with any other school or group of schools in Hong Kong and has so far been wholly financed by parents.
6. There is no defined catchment area.
7. Kellett School's sole responsibility is to the children and parents. The Company which runs the school is composed of parents, who elect the Board of Governors. With the Teaching Staff, they run the school. It is their school.

The Future

A scheme is underway to build a school on land in Pokfulam reserved by Government.

In its first phase, this will accommodate 280 children in 14 classes.

Kellett School will eventually provide a full primary education for over 400 pupils.

The school is an ambitious new venture to serve the need for an independent British School offering a choice of education to parents.

With independence comes the need for financial support without strings.

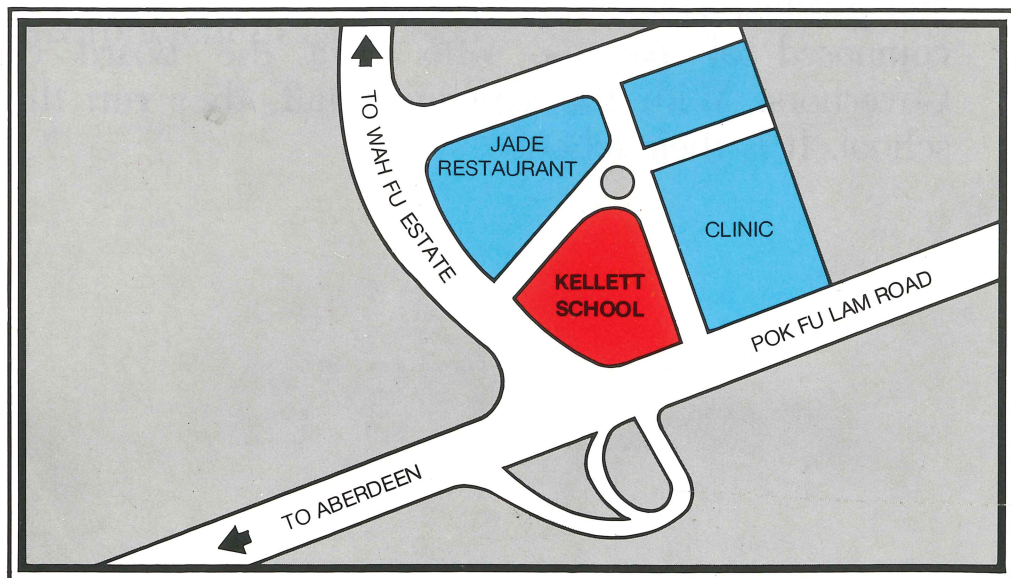

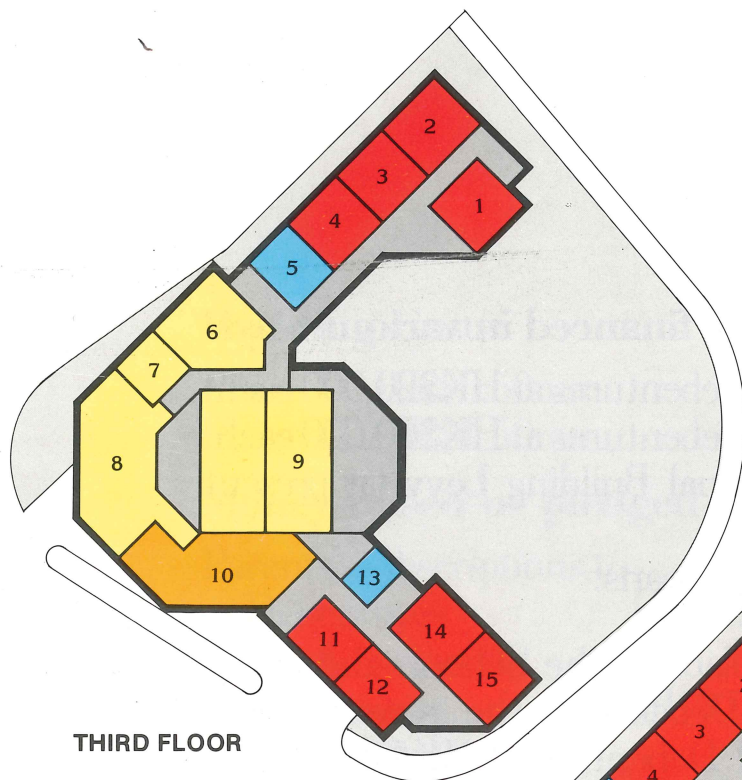

THIRD FLOOR

1. Class
2. Class
3. Class
4. Class
5. Toilets
6. Caretaker
7. Plant Room
8. Association Room
9. Roof Structure & Plant Room
10. Parents
11. Class
12. Class
13. Toilets
14. Class
15. Class

SECOND FLOOR

1. Class
2. Class
3. Class
4. Class
5. Toilets
6. Library
7. Staff
8. Head
9. General Office
10. Medical Office
11. General Purpose Hall
12. Staff Kit
13. Toilets
14. Resource
15. Class
16. Store Room
17. Toilets
18. Class
19. Class

FIRST FLOOR

1. Art 2
2. Art 1
3. Class
4. Class
5. Toilets
6. Exhibition
7. Covered Play Area
8. Music store
9. Music Room
10. Pit: (Game Store under)
11. Special Purpose Room
12. Entrance
13. General Equipment Store
14. Class
15. Class
16. Covered Area
17. Shower
18. Toilets
19. Recept 1
20. Recept 2
21. Play Area
22. Playing Field
23. Swimming Pool

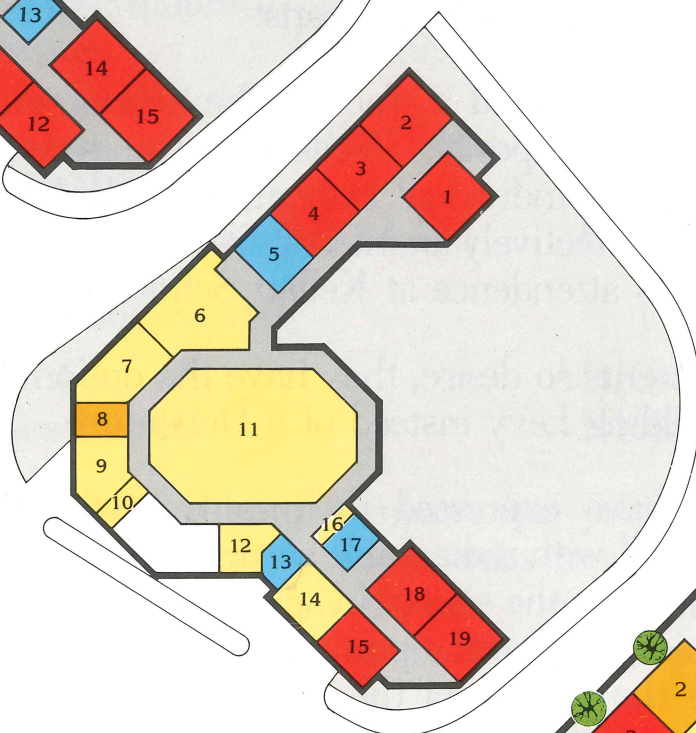

SECOND FLOOR



FIRST FLOOR

Finance

The new building is to be financed in various ways:

- a. The issue of Corporate Debentures at HK\$20,000 each.
- b. The issue of individual Debentures at HK\$10,000 each.
- c. The payment of an annual Building Levy (at present HK\$1,750)
- d. Sponsorships, donations, loans.

If a child is offered a place at the School, and is not covered by a Corporate Debenture, the parents must subscribe for an individual Debenture of HK\$10,000 per child. This is effectively an interest-free loan for the period of the child's attendance at Kellett School.

If the parents so desire, they have the option to pay an annual Building Levy instead of a Debenture.

Parents have expressed their faith in the future of Kellett School with remarkable accord. Existing pupils are being kept on at the school in spite of the extra financial burden this has placed upon parents. We feel this fact underlines the validity of the original concept.

The initial response to the offer of Corporate Debentures has been most encouraging.

Building Costs:

Phase I HK\$5.50mn.

Phase II HK\$1.50mn.

HK\$7.00 million

Money raised or pledged to date:

Parents' subscriptions to

Debentures HK\$1.09mn.

Sales of Corporate

Debentures HK\$0.34mn. HK\$1.43 million

Subscriptions to

Building Levy 26 @HK\$1,750 HK\$45,500 p.a.

Kellett School needs:

For Phase I

HK\$4.07 million

For Phases I & II

HK\$5.57 million

Whether or not your company has provisions in its budget for sponsorship of community projects and other worthwhile causes, we would ask you to consider the education of English-speaking children in Hong Kong as a priority issue.

November, 1979