

39570

78 Clinton Ave., Mlbrn.

\$275,000

1F



39570

78 Clinton Ave., Mlbrn.

\$275,000

1F

Bet: Wyoming & Sagamore Map Grid J-9

Ranch, fr, brk, comp. rf, all ss/scrs, 220 VS, 100 amps.

1st-5-ch, lr, kit, brk.nk, 2 brs, 2 baths, M. bath w/stall,
o.w/s.o.t., 1 open porch, den/fam.rm, laund,
dining area.Bsmt-3-rec.rm, out.ent, game rm, kit, wine cellar, walk-
FA: Gas Central A/C /in closet, lav.

2-car blt-in garage, paved drive

L-50, 2 B-49.4 '83 Rate \$4.18 Taxes \$4163.28 Poss:

90 days o.a.a. Approx. Eighteen-year-old Ranch on
double lot w/all large rooms & many custom features.
Oversized kit. w/laund, outside entrance & breakfast
area w/bay window. Lr has cath. ceiling, double slid-
ing glass doors to patio overlooking terraced private
yard; picture window in dining area faces wooded
side lot. Panelled den w/parquet floor & glass door
to patio. Both baths have dressing rooms w/blt-in
vanities. Bsmt. has been fully finished w/panelling,
SEE ADDITIONAL INFORMATION OVER-----

LR:S&C 762-7774 40016004/100015004 (CB 3 - \$45)

Owner: Mary Quinn, Executrix of the Estate of
Michael A. Squillaro, c/o L.R.ALL NEG. THRU L.R. SEE OVER LOTS

R.78 Clinton Ave., Mlbrn. 8-2-2-lav. 2 brs. \$275,000.

1/11/85 SOLD 205,
9/84 None

10/2/84 CONTRACT

ADDITIONAL INFORMATION:

all recessed lighting & wet bar. Included: all w/w
cptg. Call Mrs. Squillaro, 762-2420, for appts. -
if not at home, key w/L.R. & Dunn & Hartford. No
showings before noon on Friday, Saturday or Sunday.
Wyoming GS, Mlbrn. Jr. & HS, St. Rose of Lima Paro.
Bus 70. Mlbrn. RR Sta. Subject to errors & omissions.

4/26/84 1984 assessed value L-\$50,4 & \$48,5 (2 lots)
; lbdg. \$127. Total \$225,900. Don't hesitate to
show or make realistic offers.

6/28/84 Delete Mrs. Squillaro's phone #- hse. is
vacant.

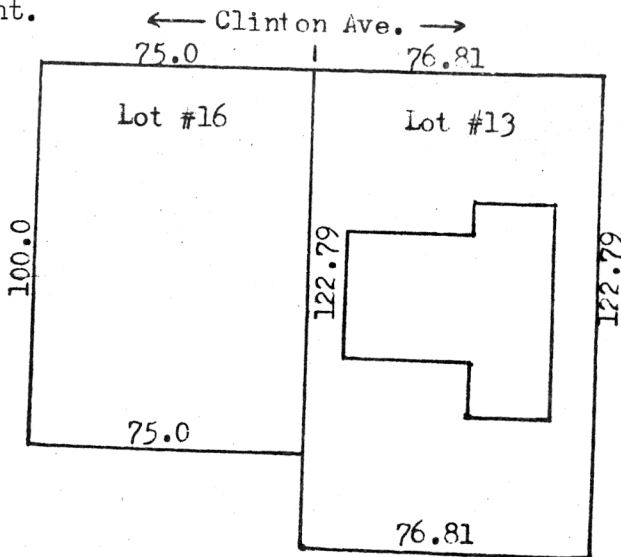

7/19/84 Price red. to \$219,900. Hse. being cleaned &
decorated. Pl. do not show until further notice.

8/7/84 Hse. can now be shown. '84 taxes Lot 16 L-50.4;
Loat 13 L-48.5; B-127.0. '84 Rate 2.19 Taxes \$4947.21.

9/18/84 Assessed value has been reduced to: Lot 13
L-48,500; B-100,400 Taxes \$3260.91. Lot # 16 has been
determined to be a bldable lot & assessed value remains
the same @ \$50,400. Total assessed value lots 13
& 16, \$199,300. Taxes 4364.67. Owner will sell hse
separately but will not sell the lot before hse.