

TYPICAL DRIP CONNECTION
NOT TO SCALE

FIRST FLOOR PLAN

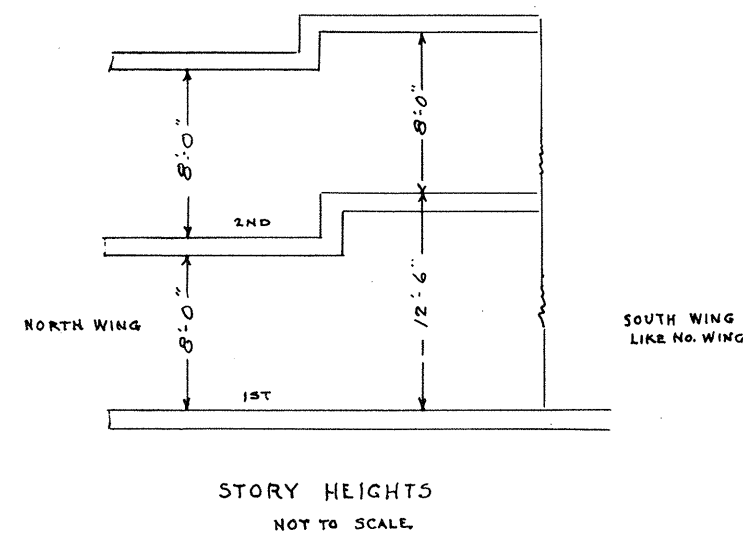

HEATING

PASSAMAQUODDY BAY
TIDAL POWER DEVELOPMENT
TEMPORARY BUILDINGS
UTILITIES BUILDING

Sheet # 11 of 12 sheets Date OCT. 1935
UNITED STATES ENGINEER OFFICE
EASTPORT, MAINE
JOHN CALVIN STEVENS ARCHITECTS
JOHN HOWARD STEVENS
THE FELS CO. HEATING ENGINEERS
PORTLAND, MAINE
Submitted by [Signature] L.T.C. of U.S.A.
Approved [Signature] MAJOR, C. of U.S.A.
DISTRICT ENGINEER