

Before Johns Creek:

Post Offices of Forsyth and Old Milton Counties

Johns Creek Historical Society

Ed Malowney

Barbara Latham

June 5, 2019

Timeline

- The Cherokee Nation
- 1820s Gold discovered in Cherokee Nation
- 1830 Cherokee County created
- 1832 Forsyth County created
- 1832 Gold Lots Survey
The Gold Lot Lottery
- 1833 Fractional lots & unclaimed lots

Timeline

- 1835 Treaty to Vacate the Cherokee Land
- 1838 “Trail of Tears”
- 1857 Milton County Created
- 1861 Free delivery to the 49 largest cities in the North
- 1864 Civil War: many Southern Post Offices closed
Soldiers sent letters by COD
- Reconstruction following the Civil War
- 1880s and 1890s: Large increase in Post Offices
- 1905 to 1907: Rural Free Delivery (RFD)

Post Offices from 1834 to 1907

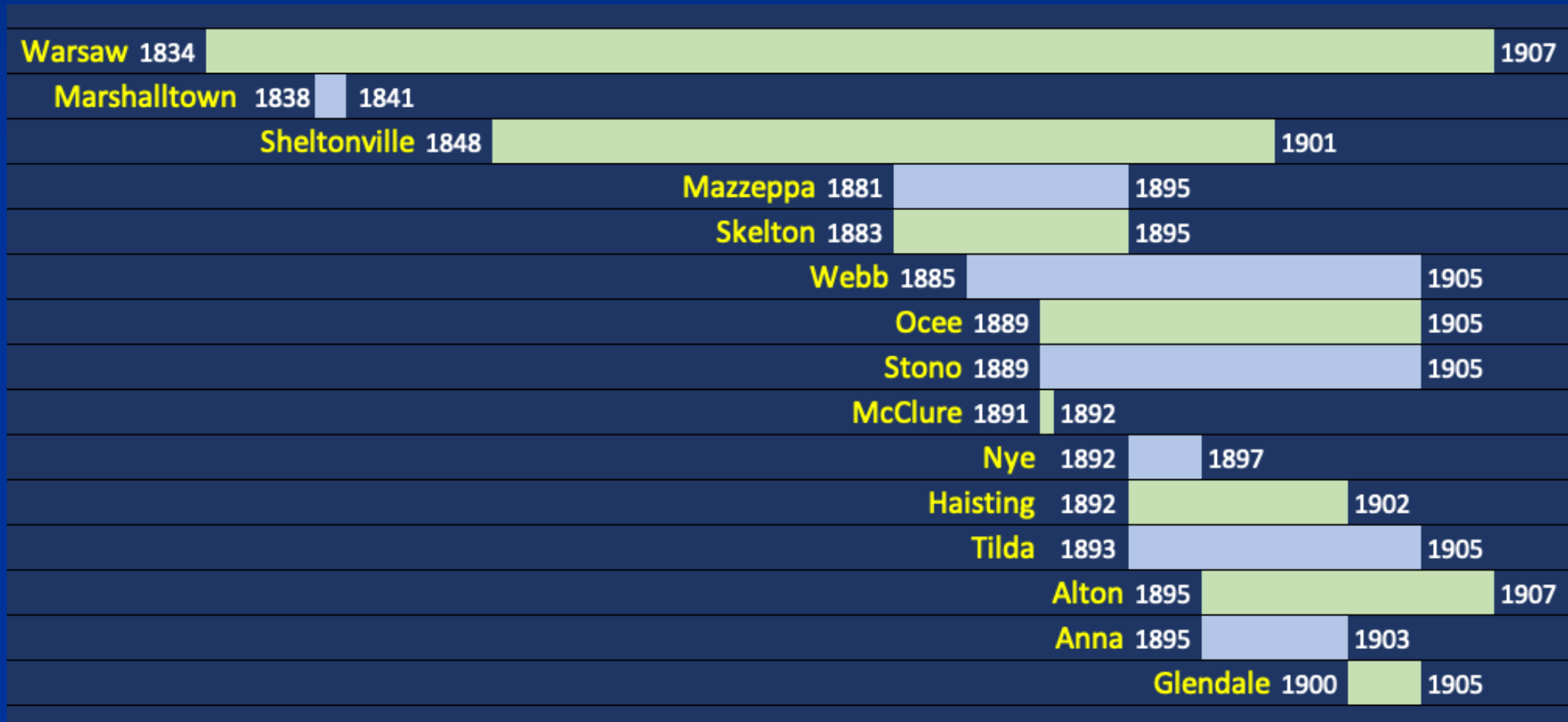

Overview: Post Office Documents

- Postal Ledger By County and Post Office
 - Post Master Appointments & Dates
 - Post Office Discontinuations and Transfers
- Form to Request a Post Office
- Request for Post Office Verification from U.S. Postal Topographer
- Maps or Diagrams describing location & community

Post Office Logs By County

Cherokee County, Ga.				34
Post	Chert Ground	James M. Kelly	1 June 1857	Post Office
		Francis M. Waldrop	15 Dec 72	
Chg	Board tree	Littleberry Holcomb	13 Feb. 1857 to "Copher"	9 Mar '58
	Counton	Calley John M. Ford	21 Apr. 1857	Milton M. Barton 5 Feb. 1858
	do	Rubin S. Daniel	15 June '59	
Dis	Cherokee Line	Knobney A. Minnott	25 Mar 1857	Discontinued 7 Mar 1859
Chg	Thornhouse	Seham Sharkey	9 Feb. 1857	Oliver S. Shelton 12 May 1858
New	Field's Cross Road	John H. Cooke	10 Oct. 1855 in	Milton C.
Dis	W. Fort Bluffington	Milton S. Richardson	5 Jan. 1857	Thos. E. Richardson 27 Sept. 57
		Jefferson Thomas	15 Dec. 74	
Dis	Waters Mill	Stephen W. King	29 June 1857	Andrew J. Riley 1 Nov. 1859
New	Freeman'sville	Joseph H. Johnston	1 May 1857	Wm. H. Anderson 5 Apr. 1858
Dis	Reet Hickory Hat	Seamus Mc. Connell	27 Jan. 1857	David Ireland 11 Apr. 1866
New	W. Spring	Colman W. Ferguson	25 Aug. 1857	Re-established 24 Oct. 73
				Discontinued 6 Dec. 1858
Dis	Little River	William J. Cowan	5 Feb. 1857	Dis.
				5 Jan. 57
Dis	Macedonia	Brown S. Holbrook	2 Aug. 1857	Re-established 19 Oct. 59
				Discontinued 24 May '59
Dis	Est. Grange	Joseph Underwood	13 Feb. 1856	Jesse M. Parry 6 Oct. 57
		Geo. J. Maddox	4 Jan. '72	
Dis	Sharp's top	Leahon Parley	20 Aug. 1857	Dis.
				7 July 58
New	Dis. Saltee	Samuel M. Mc. Connell	5 May 1857	Re-established 29 Aug. 73
				Discontinued 2 Apr. 1861
Dis	Troy	Edw. Mc. Connell	21 Aug. 1857	Dis.
				28 Sept. 56
Dis	Re. Haleson	John J. A. Sharp	4 Apr. 1856	Re-established 14 Oct. 73
				Dis. 5 Jan. 57
	Woodstock	Edw. L. Anderson	21 Apr. 1857	Thos. H. Putnam 15 Dec. '58
	do	Thos. H. Ream	15 June 55	
Dis	Grand Tree	Littleberry Holcomb	13 Mar. 1858	James L. Leonard 18 Oct. 58
	Copher			
Benjamin Logan	20 Oct. 1850	Re-established 24 Oct. 73	Dis. 12 June 55	Joseph B. Barton 24 Oct. 73
James Jordan	15 Nov. 1857	Littleberry Holcomb	26 Oct. 65	Milton Cloudy 17 Dec. 1858
Isabella (Milton Co.)	5 Oct. 58			
Jefferson Thomas	21 Apr. 57	Re-established 13 May 58	George Thomas	13 May 58
Discontinued	7 July 1861			
in Milton Co.				
Discontinued	27 Aug. 55	Chas. Northcutt	27 Feb. 52	Miss Tanya H. Wiley 24 Mar. '55
Wm. Rapedale	24 Oct. 73			
James M. Shilling	10 Oct. 1857	Discontinued	17 Mar. 1862	
Re-established	20 Aug. 57	J. Underwood	20 May 59	Joseph Underwood 10 July 1857
Dis.				
Wm. F. Evans	6 June 73	H. Hedgescock	16 Mar. 74	James H. Hedgescock 4 Dec. 74
Thos. A. H. Sharp	16 July 73			
Lucas A. Haddon	11 Jan. 58	Miss E. A. Sylvester	3 Sept. 73	Miss Marcie Fowler 18 Dec. 74
Dis	Re-established 5 Jan. 57	John A. Donald	7 Oct. 57	

Request for a Post Office Application Form

No. 1011. (LOCATION PAPER.)

Post Office Department,
OFFICE OF THE FOURTH ASSISTANT POSTMASTER GENERAL,
APPOINTMENT DIVISION.

JUN 18 1900
WASHINGTON, D. C., 1900

SIR: Before the Postmaster General decides upon the application for the establishment of a post office at _____, County of _____, State of _____, it will be necessary for you to carefully answer the subjoined questions, get a neighboring postmaster to certify to the correctness of the answers, and return the location paper to the Department, addressed to me. If the site selected for the proposed office be not on any mail route, only a "Special Office" can be established, to be supplied with mail from some convenient point on the nearest mail route by a special carrier, for which service a sum equal two-thirds the salary of the postmaster will be paid by the Department.

You should inform the contractor, or person performing service for him, of this application, and require him to execute the appended certificate as to the practicability of supplying the proposed office with mail.

Very respectfully,
J. H. Ristow
Fourth Assistant Postmaster General.

To Mr. *Dougan Fouts*
care of the Postmaster of *Roswell, Ga.*, who will please forward to him.

STATEMENT.

The proposed office to be called *Fulton*
Gopher Milton - G. F.

Notice directions for selecting post office names on next page.

It will be situated in the _____ quarter of Section _____ Township _____ (North or South),
Range _____ (East or West), _____ in the County of *Milton* State of *Ga.*
It will be on _____ route No. *21253* being the route from *Roswell*
to *Coker* on which the mail is now carried *3* times per week.
Will it be directly on this route?—Ans. *Yes*
If not, how much would its supply on this route increase the distance necessarily traveled by the carrier in going once over the route?—
If not on any route, is a "Special Office" wanted?—Ans. _____ To be supplied from *Roswell, Ga.*
The name of the nearest office to the proposed one, on one side, is *Roswell* *South*
its distance is *3* miles in a *SE* direction from the proposed office.
The name of the nearest office, on the other side, is *Coker* *North*
its distance is *2* miles in a *W* direction from the proposed office.
The name of the other nearest office to the proposed one is *Coker W. B.*
its distance by the most direct road is *2* miles in a *W* direction from the proposed office.
The name of the most prominent river near it is *Chattahoochee*
The name of the nearest creek is *Big Creek*
The proposed office will be *4* miles from said river, on the *North* side of it, and will be *4* miles from said nearest creek, on the *South* side of it.
The name of the nearest railroad is *Southern*
If on the line of or near a railroad, on which side will the office be located; how far from the track; and what is, or will be, the name of the station?—Ans. _____
Give the population to be supplied by the proposed office.—Ans. *200*
If it be a village, state the number of inhabitants.—Ans. _____
A diagram, or sketch from a map, showing the position of the proposed new office, with neighboring river or creek, roads, and other post offices, towns, or villages near it, will be useful, and is therefore desired.

ALL WHICH I CERTIFY to be correct and true, according to the best of my knowledge and belief, this _____ day of *June*, 1900.

(Sign full name.) *Dougan Fouts* Proposed P. M.

I CERTIFY that I have examined the foregoing statement, and that it is correct and true, to the best of my knowledge and belief.
(This must be signed by Postmaster at nearest office.)
J. B. Moore
Postmaster at *Roswell*

At a "special office" the postmaster is authorized to employ a carrier to supply the office as often as practicable, for a not exceeding two-thirds of the postmaster's compensation.

Applications for post offices should be accompanied by petitions of the citizens interest

Postal Verification Form

F.M.P.

DIVISION OF
POSTMASTER GENERAL
(TOPOGRAPHY BRANCH)

Post Office Department

FOURTH ASSISTANT POSTMASTER GENERAL

Washington May 14, 1923.

A

Postmaster,

Alpharetta

Milton Co

Fulton Co.

Ga.

POST OFFICE DEPT.
DIVISION OF TOPOGRAPHY

JUN 9 1923

Consolidated Jan. 1, 1932

In order that the site of your post office may be accurately represented upon the post-route maps, it is requested that you carefully answer the questions below and furnish a sketch, according to instructions on opposite side of paper, which should be returned to this Division as soon as possible.

FOURTH ASSISTANT POSTMASTER GENERAL.

The name of my post office is

Alpharetta, Ga.

If the town, village, or site of the post office be known by another name than that of the post office, state that other name here:

My post office is situated in the Central part of Alpharetta, Ga. Township,

or in _____ quarter of tract _____

County of Milton ^{Number.} Fulton State of Georgia ^{Name.} _____ Township,

The name of the nearest river is Chattahoochee and the post-office building is at a distance of _____ on the _____ side of it.

The name of the nearest creek is Big Creek and the post-office building is at a distance of 17/8 miles on the W. side of it.

The name of the nearest office on my route is Roswell, Ga. and its distance is 7 miles, by the traveled road, in a S/W direction from this, my office.

The name of the nearest office on my route, on the other side, is Cumming, Ga. and its distance is 16 1/2 miles, in a N/E direction from this, my office.

The name of the nearest office not on my route is Duluth, Ga. and its distance is 12 miles, by the traveled road, in a E direction from this, my office.

The post-office building is on the _____ side of the _____ Railroad, and at a distance of _____ from the track.

The railroad station name is Not any

The air-line distance from my post office to the nearest point of my county boundary is 5 1/4 miles in a S/W direction.

Postmaster:

Ralph A. Hature

Date: June 7, 1923

DIAGRAM, EXPLANATION, AND INSTRUCTIONS.

The dot in the center of the 1-mile circle represents the site of your office. The surrounding offices should be carefully located by plane and

The surrounding offices should be carefully located by placing dots on or between the mile circles at the exact distance, and in the right direction from the proposed one, and their names plainly written.

If it should be necessary to designate an office which is over 10 miles from the proposed one, place the dot outside of the 10-mile circle, write the name of such office, and state its distance from the proposed one.

Draw distinctly the railways, roads, rivers, and creeks.

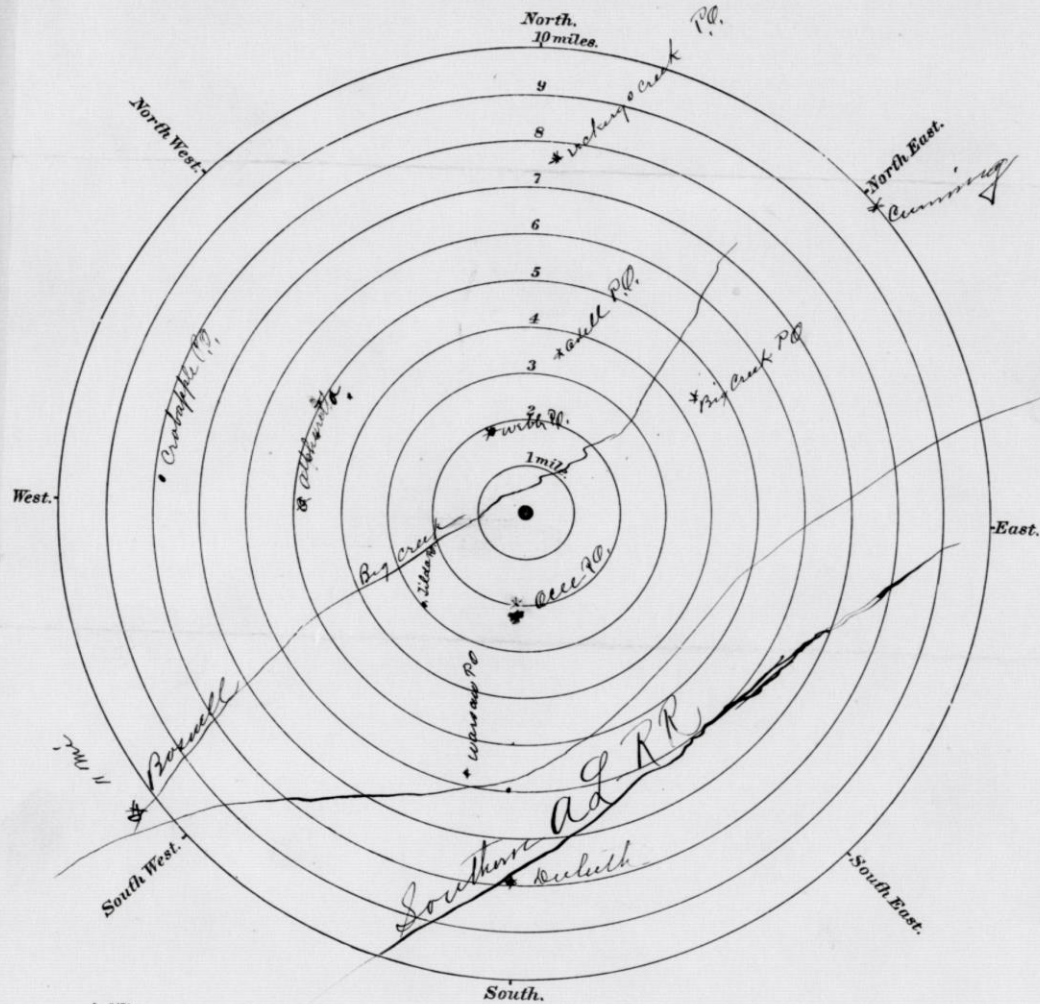

Circle Diagram

Graph Diagram

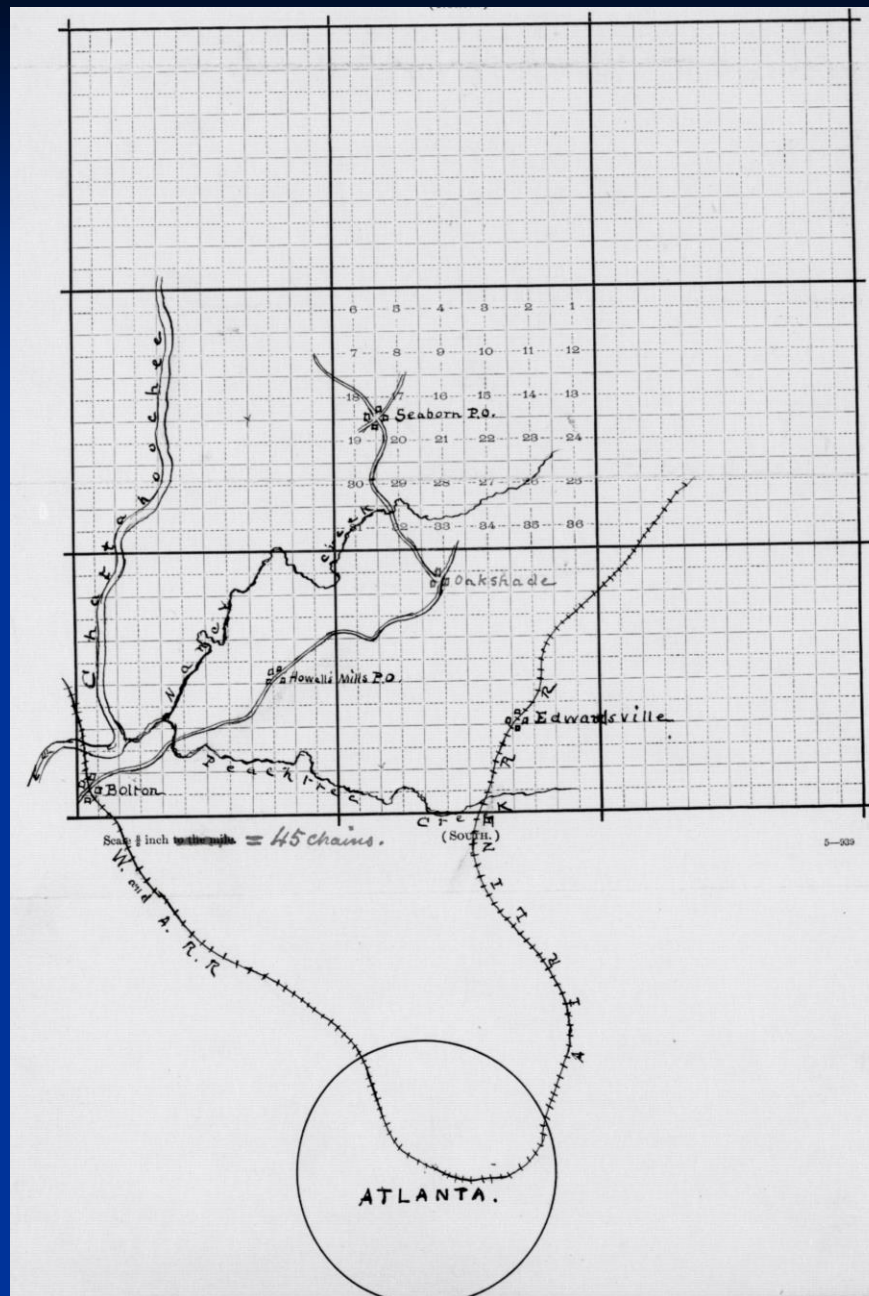

Warsaw Post Office (oldest)

- Warsaw Post Office approved January 13, 1834
- 3rd Post Office established in Forsyth County
- Located on Gold Lots 372-1-1 and 299-1-1

Warsaw Gold Lot 299-1-1

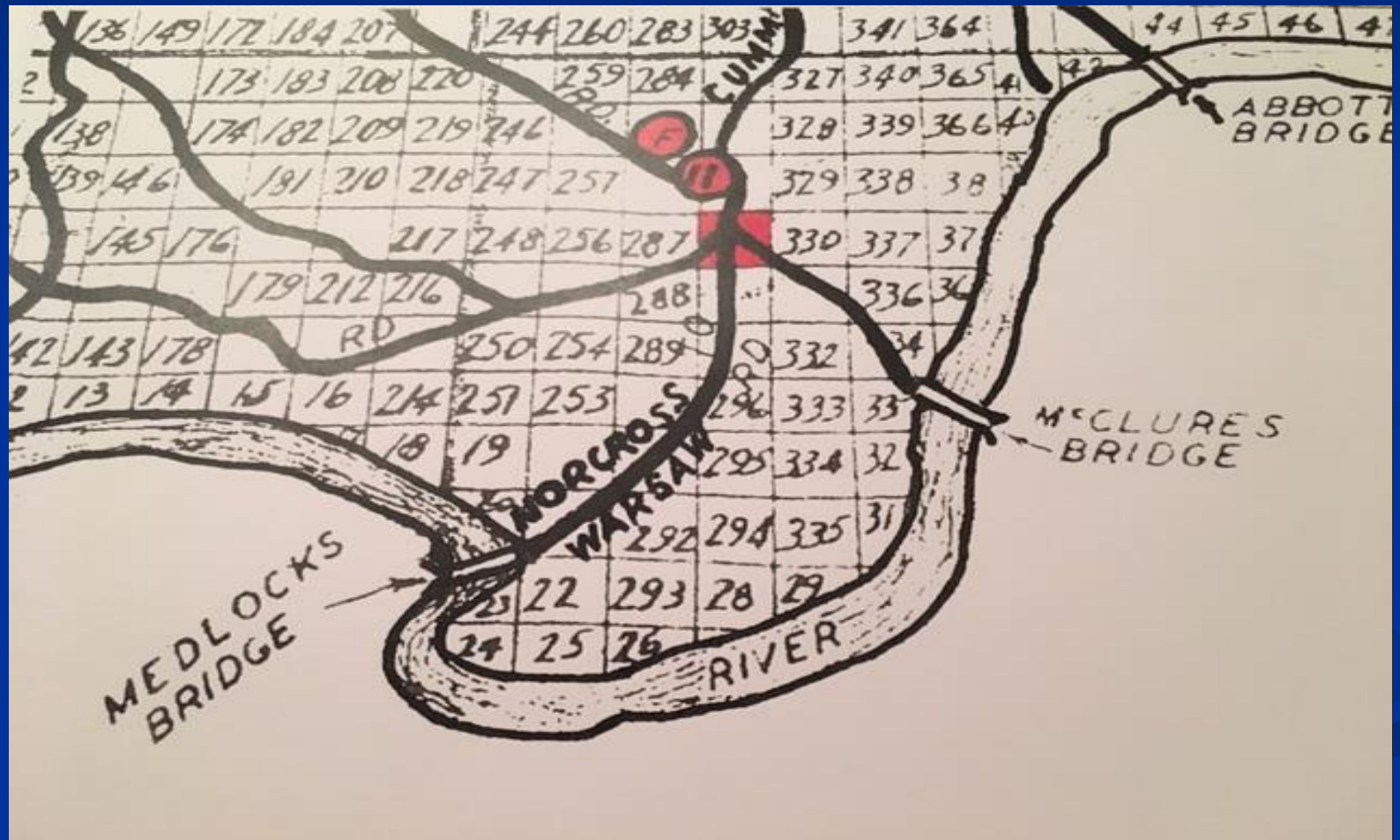

Warsaw Post Masters

- Hiram Rousseau 1834 *
- Clark Howell 1845 *
- William Autrey 1851 *
- Jackson Graham 1854 *
- William W Anderson 1867
- Armstead T. Abbott 1879
- Andrew J. Cain 1884
- William T. Abbott 1887
- Grun H Collins 1893
- Kate Anderson 1894
- John N. McClure 1895
- John C. Abbott 1897
- Calvin M. Parsons, Jr. 1902
- William H. Barnett 1907
- Theodore C. Nunnely 1907

* Warsaw was in Forsyth County until Milton County was created in 1857

When rural delivery began...

- Robert “RD” Medlock was postal carrier for Warsaw Community

Marshalltown Post Office

- Post Office was approved February 3, 1838
- Located on Fraction Land Lot # 12 on the Chattahoochee Riverfront
- Its only Post Master was Daniel N. Pittman, a wealthy land owner in Pinckneyville
- Post Office was discontinued in June 1, 1841

Marshalltown: Fractional Lot 12

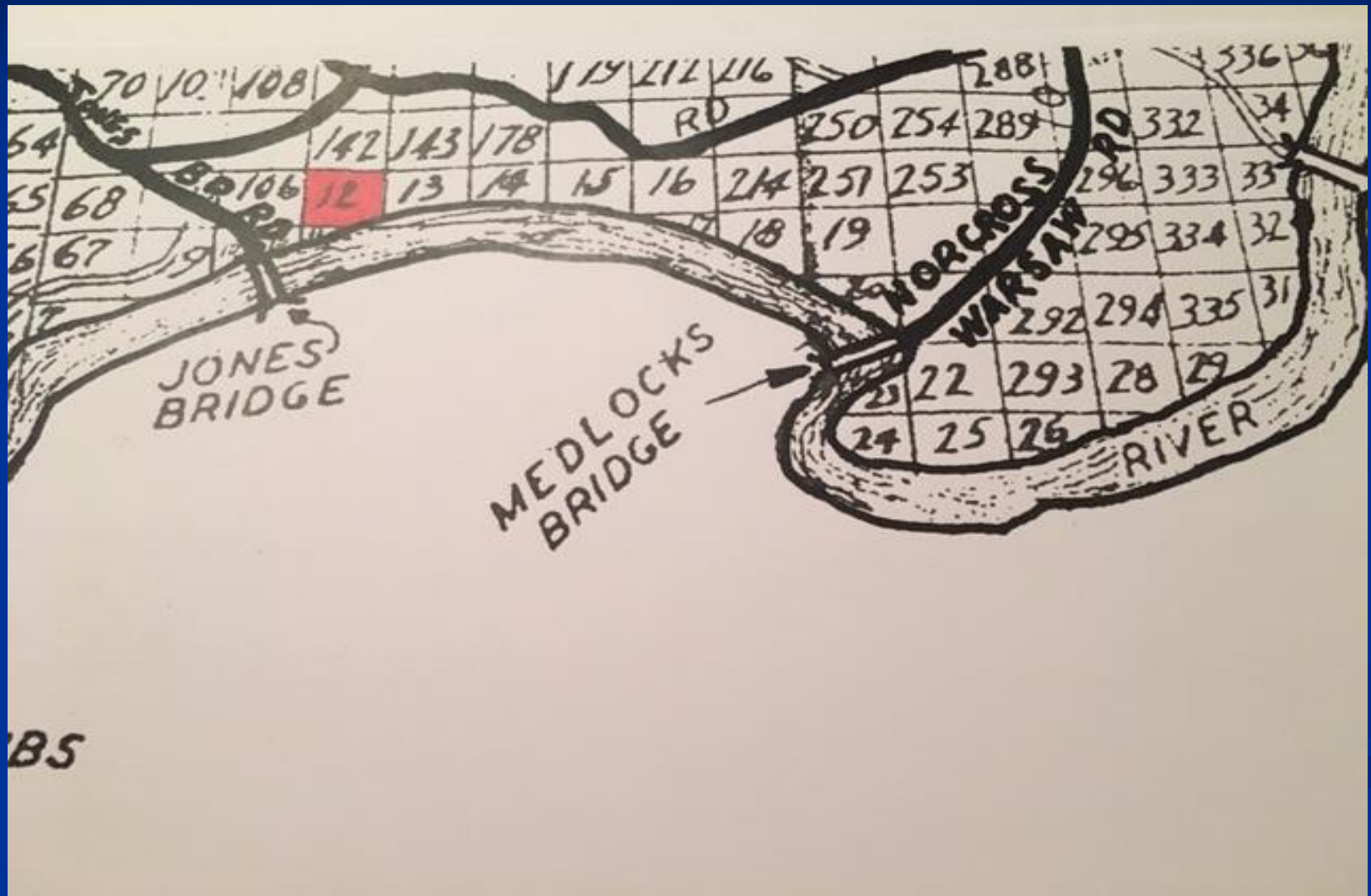

Railroad Historical Marker

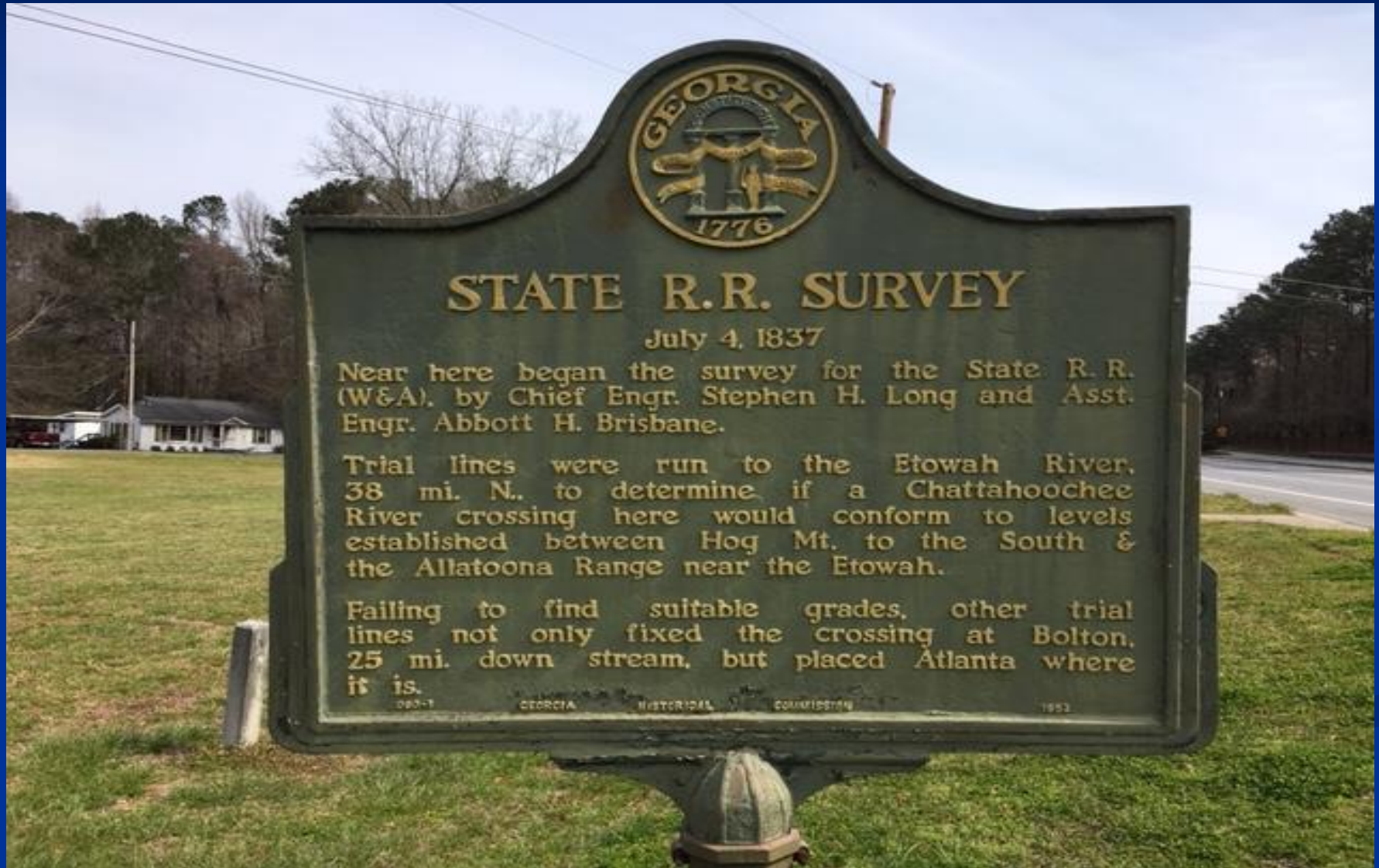

McClure Post Office

- Established on October 27, 1891
- Its first and only Post Master was Louella “Ella” Medlock, wife of William Oliver Medlock
 - Operated the Medlock Ferry
 - Self financed and operated Medlock toll Bridge
- The original application was forwarded to Ella Medlock. The requested name for the office was May, but it was changed to McClure
- The McClure Post Office was closed July 20, 1892

McClure
(not May)

Be careful to answer the inquiries fully and accurately, or the case will not be acted upon.

Fourth Ass't Postmaster General.

To Mr. Ella Medlock
care of the Postmaster of Magoffin, who will please forward to him.

STATEMENT.

The proposed office to be called May McClure

Select a short name for the proposed office, which, when written, will not resemble the name of any other post office in the State.

It will be situated in the _____ quarter of Section _____, Township _____ (North or South), Range _____ (East or West), in the County of Milliken, State of Georgia.

It will be on or near route No. 15202, being the route from Chapinville to Dublin, on which the mail is now carried 4x times per week.

Will it be directly on this route?—Ans. Yes
If not, how far from it?—Ans. 2 miles
If not on any route, is a "Special Office" wanted?—Ans. Yes. To be supplied from Warsaw.

The name of the nearest office to the proposed one, on one side, is (2 1/2 miles) Warsaw, its distance is 2 1/2 miles in a North direction from the proposed office.

The name of the nearest office, on the other side, is Warsaw, its distance is 2 1/2 or 4 miles in a South direction from the proposed office.

The name of the other nearest office to the proposed one is Dublin, its distance by the most direct road is 5 miles in a North direction from the proposed office.

The name of the most prominent river near it is Chatahochee
The name of the nearest creek is Gators Creek
The proposed office will be _____ miles from said river, on the West side of it, and will be _____ miles from said nearest creek, on the East side of it.

The name of the nearest railroad is Richmond & Greenville
If on the line of or near a railroad, on which side will the office be located; how far from the track; and what is, or will be, the name of the station?—Ans. near May

If it be a village, state the number of inhabitants.—Ans. in Country
Also, the population to be supplied by the proposed office.—Ans. 250

A diagram, or sketch from a map, showing the position of the proposed new office, with neighboring river or creek, roads, and other post offices, towns, or villages near it, will be useful, and is therefore desired.

A correct map of the locality might be furnished by the county surveyor, but this must be without expense to the Post Office Department.

ALL WHICH I CERTIFY to be correct and true, according to the best of my knowledge and belief, this _____ day of _____, 18 ____.

(If Sign full name.) Ella Medlock Proposed P. M.

I CERTIFY that I have examined the foregoing statement, and that it is correct and true, to the best of my knowledge and belief.

John V. Simes
Postmaster at Magoffin

Applications for post offices should be accompanied by petitions of the citizens interested.

McClure Post Office: Fractional Lot 21

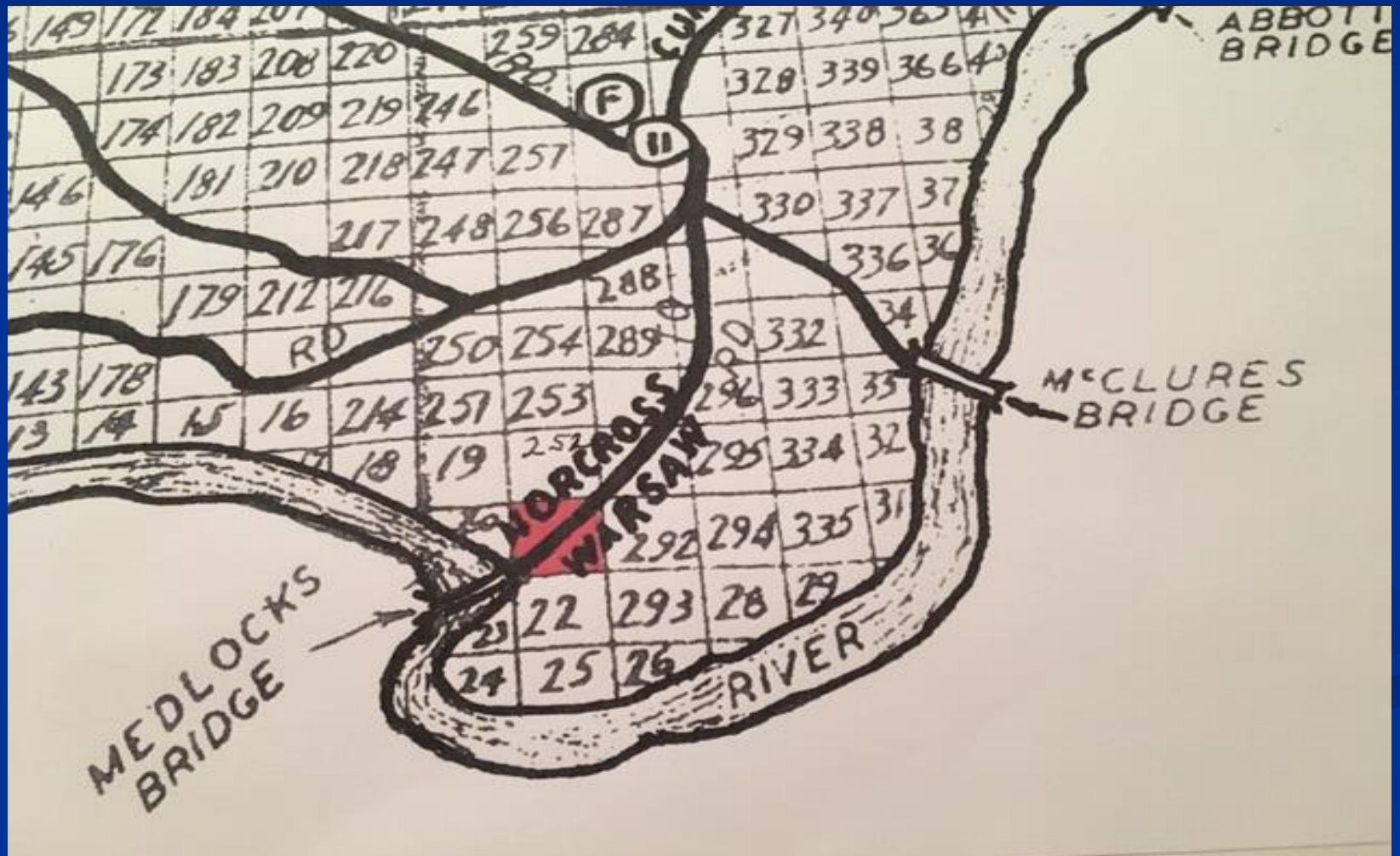

Medlock Bunkhouse and Maude Brown's Store



Sheltonville Post Office

- Established October 27, 1848
- Site was on Gold Land Lot 472-1-1 on southeast corner of McGinnis Ferry at Bell Road
- Post Office was discontinued April 30, 1907
- Robert “RD” Medlock became mail carrier with rural delivery service

Sheltonville Gold Lot 472

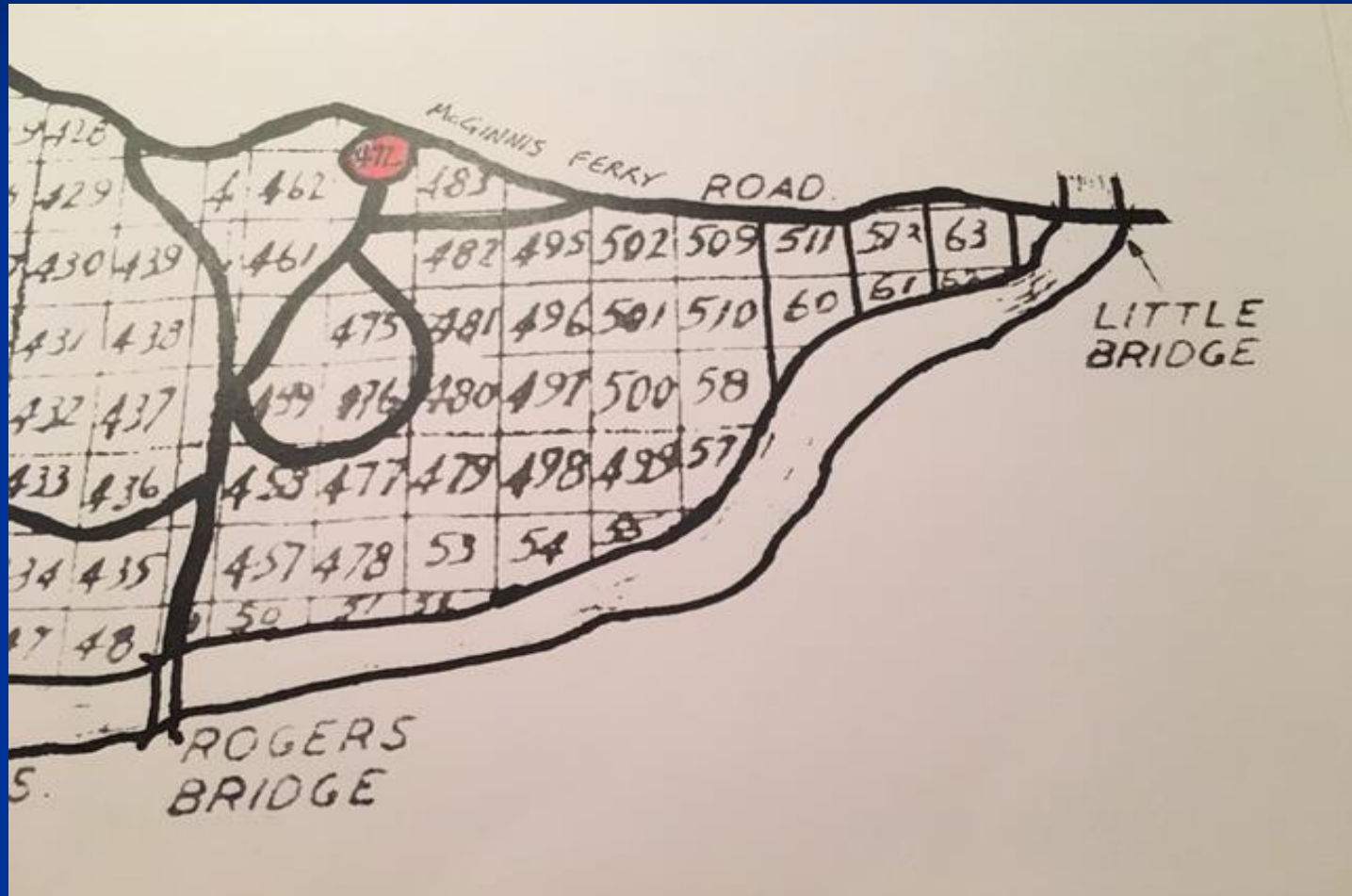

Sheltonville

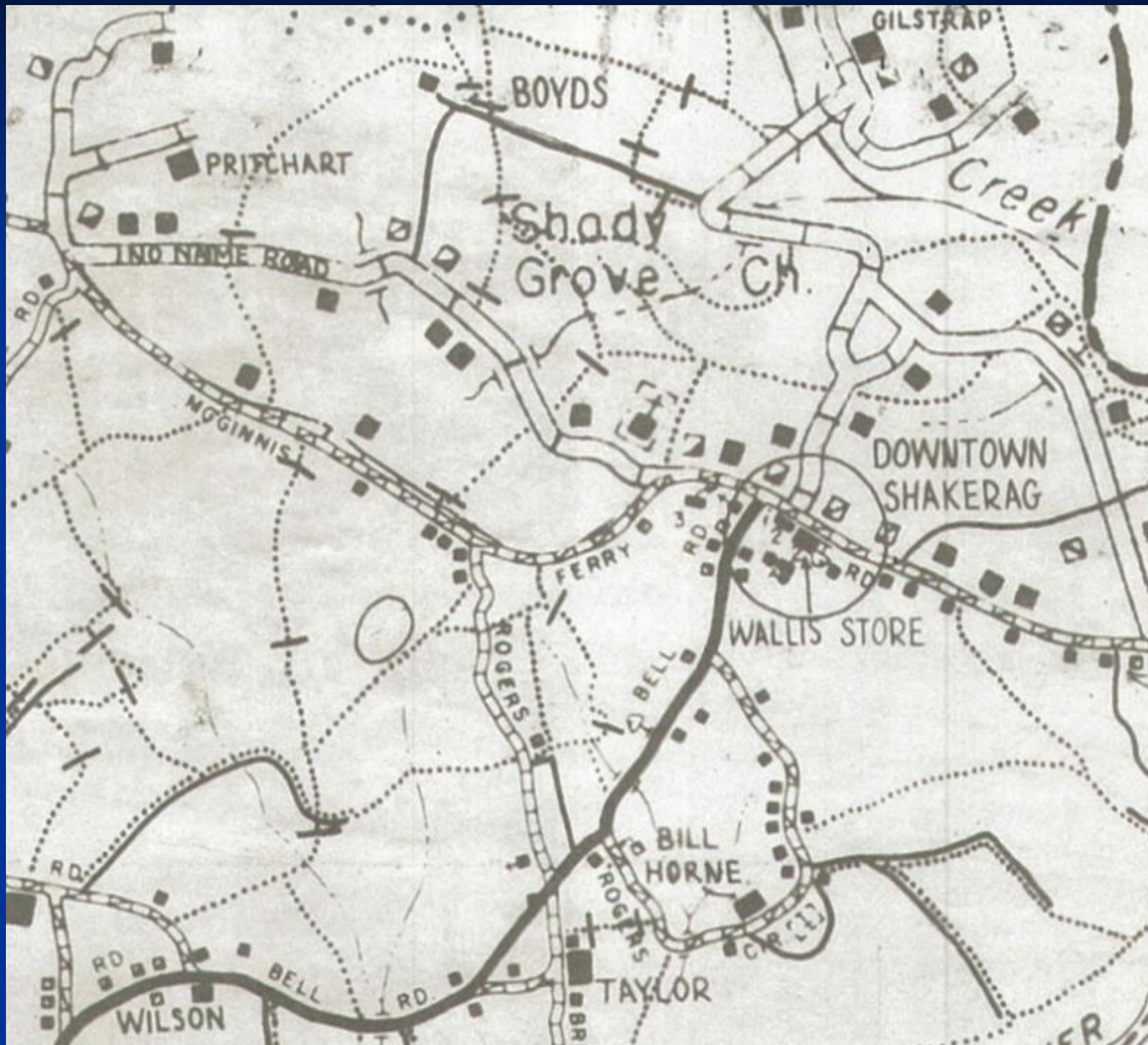

The Many Names of Sheltonville

- Rogers
- Chattahoochee
- Oakland
- Shady Grove
- Sheltonville
- Liberty Valley
- Shakerag

Sheltonville Post Masters

- Vardy B. Shelton 1848 *
- George W. Rogers 1852*
- John H. Campbell 1854 *
- John M. Green 1857 *
- Thomas Collins 1858 *
- Hiram Mathis 1867
- Charleston Collins 1874
- Green Collins 1876
- Green H. Collins 1886
- Thomas L Collins 1893
- James N. Pierce 1900
- N.J. Roach 1901
- Lou A. Allen 1901
- Ida Burton 1901

*Denotes Forsyth County; transferred to Milton County in 1857

The mail was discontinued September 28, 1866 and reestablished July 10, 1867

The Post office was discontinued April 30, 1907 with Rural free Delivery out of the Office

Alton Post Office

- Established April 2, 1895
- First Post Master Benjamin J. Findley wanted the Post office to be called Selma
- Post Masters included:
 - Benjamin J. Findley 1895
 - Mattie B. Gant 1901
 - Benjamin J. Findley 1902
 - Singleton B. Moudler 1906
- Discontinued March 31, 1907

Alton
(not Selma)

No. 16 Memphis
Fourth Assistant Postmaster General.

To Mr. B. J. Findley
care of the Postmaster of Chiltonville, who will please forward to him.

STATEMENT. Alton

The proposed office to be called Selma

Select a short name for the proposed office, which, when written, will not resemble the name of any other post office in the State.

It will be situated in the _____ quarter of Section _____, Township _____ (North or South), Range _____ (East or West), in the County of _____, State of _____

It will be on or near route No. _____, being the route from Cumming to Aduluth, on which the mail is now carried Six times per week.

Will it be directly on this route?—Ans. No. It is $\frac{3}{4}$ of a mile south of it

If not, how far from it?—Ans. $\frac{3}{4}$ of a mile

If not on any route, is a "Special Office" wanted?—Ans. * To be supplied from _____

The name of the nearest office to the proposed one, on one side, is Chiltonville
its distance is three and one half miles in a East direction from the proposed office.

The name of the nearest office, on the other side, is Ocell
its distance is four miles in a West direction from the proposed office.

The name of the other nearest office to the proposed one is Warson
its distance by the most direct road is three and half miles in a South direction from the proposed office.

The name of the most prominent river near it is Chattahoochee

The name of the nearest creek is John's Creek

The proposed office will be three miles from said river, on the North side of it, and will be two miles from said nearest creek, on the East side of it.

The name of the nearest railroad is R. & D.

If on the line of or near a railroad, on which side will the office be located; how far from the track; and what is, or will be, the name of the station?—Ans. It is not on any R. R.

If it be a village, state the number of inhabitants.—Ans. It is not a village.

Also, the population to be supplied by the proposed office.—Ans. 300

A diagram, or sketch from a map, showing the position of the proposed new office, with neighboring river or creek, roads, and other

Alton at Findley Farm

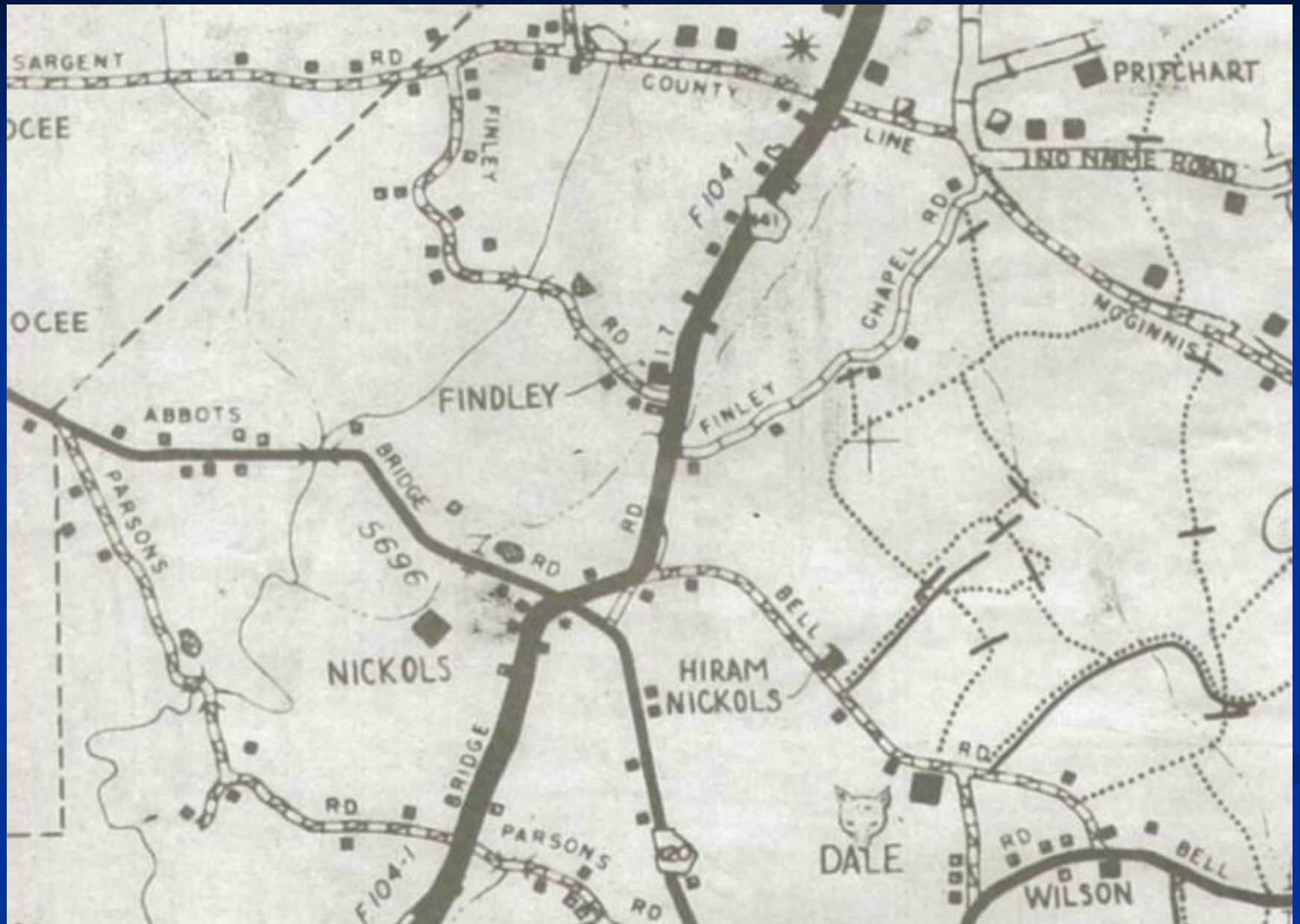

Anna Post Office

- Established April 15, 1895
- First and only Post Master was Ransom J. Autrey
- Site was Autrey Mill
- Discontinued February 28, 1903

Autrey Mill



Skelton Post Office

- On June 28, 1883, the first assistant to the Post Master General sent an application for a Post Office in Newtown.
 - *Note - this is the earliest reference to Newtown as a community in the postal records*
- The proposed Post Office was to be called “Schelton” which was crossed out on the form and the name “Skelton” was written to the right side
- Established July 16, 1883; certified by Oliver P. Skelton
- Discontinued 1895; transferred to Nye

Nye Post Office

- Established May 9, 1892
- William G. Scott is the first Post Master
- William A. Darnell takes over in 1897
- Discontinued June 1, 1897, mail transferred to Anna

Nye
(not Troy)

Be careful to answer the inquiries fully and accurately, or the case will not be acted upon.

Applications for post offices should be accompanied by petitions of the citizens interested.

E. J. Rathbone
Fourth Ass't Postmaster General.

To Mr. W. G. Scott

care of the Postmaster of Milton, who will please forward to him.

STATEMENT.

The proposed office to be called
Troy Nye

Select a short name for the proposed office, which, when written, will not resemble the name of any other post office in the State.

It will be situated in the _____ quarter of Section _____ Township _____ (North or South), _____ Range _____ (East or West), _____ in the County of Milton State of Georgia.

It will be on or near route No. 21 21 7 15 201 being the route from Alpharetta to Milton, on which the mail is now carried Fast times per week.

Will it be directly on this route?—Ans. No.

If not, how far from it?—Ans. About one-half mile.

If not on any route, is a "Special Office" wanted?—Ans. Yes. To be supplied from Milton Alpharetta.

The name of the nearest office to the proposed one, on one side, is Milton its distance is 1 1/4 miles in a Easterly direction from the proposed office.

The name of the nearest office, on the other side, is Decatur its distance is Six miles in a Westerly direction from the proposed office.

The name of the other nearest office to the proposed one is Alpharetta its distance by the most direct road is 4 1/2 miles in a Northward direction from the proposed office.

The name of the most prominent river near it is Chattahoochee.

The name of the nearest creek is Viators's Creek.

The proposed office will be Three miles from said river, on the West side of it, and will be 1 1/4 miles from said nearest creek, on the South side of it.

The name of the nearest railroad is Richmond & Danville.

If on the line of or near a railroad, on which side will the office be located: how far from the track; and what is, or will be, the name of the station?—Ans. _____

If it be a village, state the number of inhabitants.—Ans. _____

Also, the population to be supplied by the proposed office.—Ans. Eighty.

A diagram, or sketch from a map, showing the position of the proposed new office, with neighboring river or creek, roads, and other post offices, towns, or villages near it, will be useful, and is therefore desired.

A correct map of the locality might be furnished by the county surveyor, but this must be without expense to the Post Office Department.

ALL WHICH I CERTIFY to be correct and true, according to the best of my knowledge and belief, this 15th day of March, 1892.

(Sign full name.) William G. Scott Proposed P. M.

I CERTIFY that I have examined the foregoing statement, and that it is correct and true, to the best of my knowledge and belief.

John M. Lamberti
Postmaster at Milton Co.

A hand-drawn map on a grid, oriented with North at the top. The map shows a proposed railroad route, labeled 'R.T.D. R.R.' at the bottom left. The route starts near 'Browell' and 'Dickens Creek', passes through 'Skilton' and 'Mansaw', and ends near 'Duluth' and 'Norcross'. Other locations marked include 'Alpharetta' at the top, 'Mableton' and 'Mableton Acc.' on a diagonal line, and 'Chattahoochee River' on the left. A numbered grid is overlaid on the map, with numbers 1 through 36 arranged in a 6x6 pattern. The grid numbers are: Row 1: 6, 5, 4, 3, 2, 1; Row 2: 7, 8, 9, 10, 11, 12; Row 3: 15, 16, 17, 18, 19, 20; Row 4: 23, 24, 25, 26, 27, 28; Row 5: 31, 32, 33, 34, 35, 36. The map is drawn on a grid with a dashed line for the river and solid lines for the railroad route.

(North.)

Glendale

- Established April 11, 1900
- First and only Post Master is William G. Scott
- Discontinued April 15, 1905, mail transferred to Roswell

Skelton, Nye, and Glendale

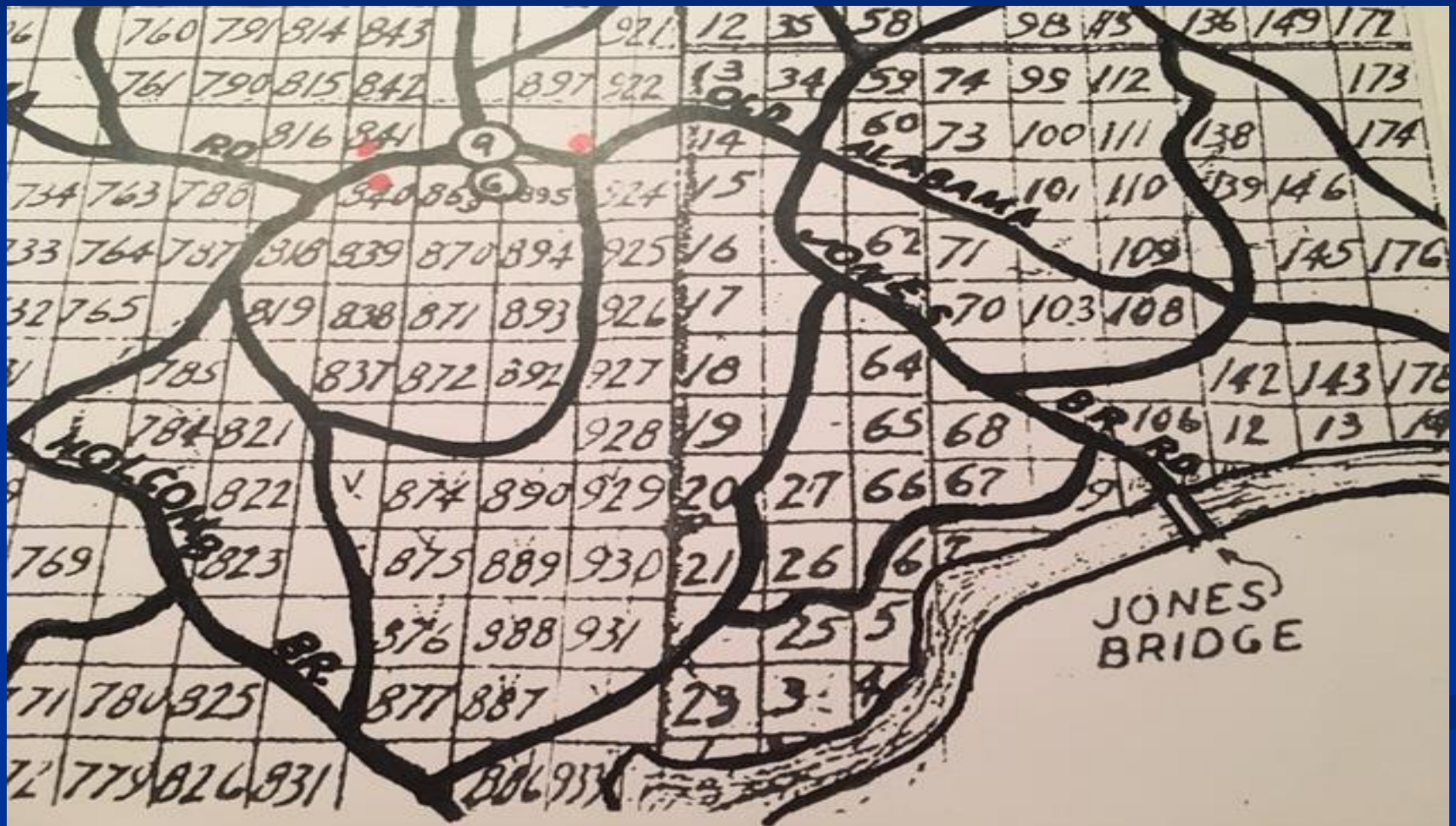

Milton County 1899



Source: Central of Georgia Railway Map of Alabama and Georgia, 1899

Mezappa

- The area requesting the post office was known as “New York”
- The proposed name is Abbottville, but Mezappa was assigned instead
- Established January 4, 1881
- Discontinued October 17, 1895, mail transferred to Tilda

Mazeppa – New York area (not Abbottville)



(1004.)

Post Office Department,

OFFICE OF THE FIRST ASSISTANT P. M. GENERAL,

WASHINGTON, D. C., 22 May, 1880.

SIR: Before the Postmaster General decides upon the application for a new post office at New York, County of Fulton, State of New York at which you are recommended for postmaster, he requires that the blanks in the following statement be filled, and the questions carefully and correctly answered, verified by your signature, certified by a neighboring postmaster, and returned to this Department, addressed to me. The contractor should be informed of this application; and if the site of the proposed office be off the mail route, you will forward his certificate as to the practicability of supplying it, and also as to the increase of distance. If the proposed office is not on any route now under contract, it can only be established as a "Special Office," to be supplied without expense to the Department other than net proceeds.

Be careful to designate the post offices by their true official names; and answer the subjoined queries fully and accurately, or the case will not be acted upon.

Very respectfully,

JAMES N. TYNER,

First Assistant Postmaster General.

To Mr. James N. Tyner
care of the Postmaster of Abbottville, who will please forward it.

The proposed office to be called

STATEMENT.

[The name of the candidate for postmaster should not be applied as the name of a post office. It is preferable to have some LOCAL or PERMANENT name, which must not be the name of any other office in the State; and you should aim to select a name not appropriated to any office in the United States.]

It will be situated on the 104 quarter of Section 1227, Township Dist., Range 104, in the County of Williston, State of Georgia.

It will be near near route No. 115390, being the route from Danville to Marion, on which the mail is now carried 1 times per week.

The contractor's name is R. A. Gump

Ocee Post Office

- Application requested the name Clement, but Ocee was assigned instead
- Established December 3, 1889
- Post Masters are
 - Clinton Webb
 - Matilda Morton Webb (Clinton Webb's widow)
 - Matilda Buice (Matilda Webb remarries - William Buice)
 - Green H. Collins
 - James Paris
 - Matthew Cunningham
 - Benjamin Shirley
- Discontinued April 11, 1905

Ocee
(not Clement)

(No. 1011—NEW SERIES—JULY 1, 1889.) (LOCATION PAPER.)

OFFICE OF FIRST ASSISTANT
RECEIVED
NOV 15 1889
POST MASTER

Post Office Department,
OFFICE OF THE FIRST ASSISTANT P. M. GENERAL,
Washington, D. C., Nov. 9, 1889

SIR: Before the Postmaster General decides upon the application for the establishment of a post office at Harrison, County of Milton Fulton, State of Ga., it will be necessary for you to carefully answer the subjoined questions, get a neighboring postmaster to certify to the correctness of the answers, and return the location paper to the Department addressed to me. If the site selected for the proposed office should not be on any mail route now under contract, only a "Special Office" can be established there, to be supplied with mail from some convenient point on the nearest mail route by a special carrier, for which service a sum equal to two-thirds of the amount of the salary of the postmaster at such office will be paid by the Department.

You should inform the contractor, or person performing service for him, of this application, and require him to execute the inclosed certificate as to the practicability of supplying the proposed office with mail, and return the same to the Department.

Very respectfully,
J. S. Clarkson
First Ass't Postmaster General.

To Mr. Clinton Webb
care of the Postmaster of Mazepa

STATEMENT.

The proposed office to be called Clement Ocee.

Select a short name for the proposed office, which, when written, will not resemble the name of any other post office in the State.

It will be situated in the _____ quarter of Section _____, Township _____ (North or South), _____ Range _____ (East or West), _____, in the County of Milton State of Georgia

It will be on or near route No. 15202, being the route from Alpharetta to Duluth

accurately, or the case will not be acted upon.

Applications for post offices must be accompanied by a certificate from the contractor, or person performing service for him, as to the practicability of supplying the proposed office with mail, and return the same to the Department.

Other Old Milton Post Offices

- Haisting
- Groganville
- Stono
- Tilda
- Webb
- Farmhouse

Milton County 1899

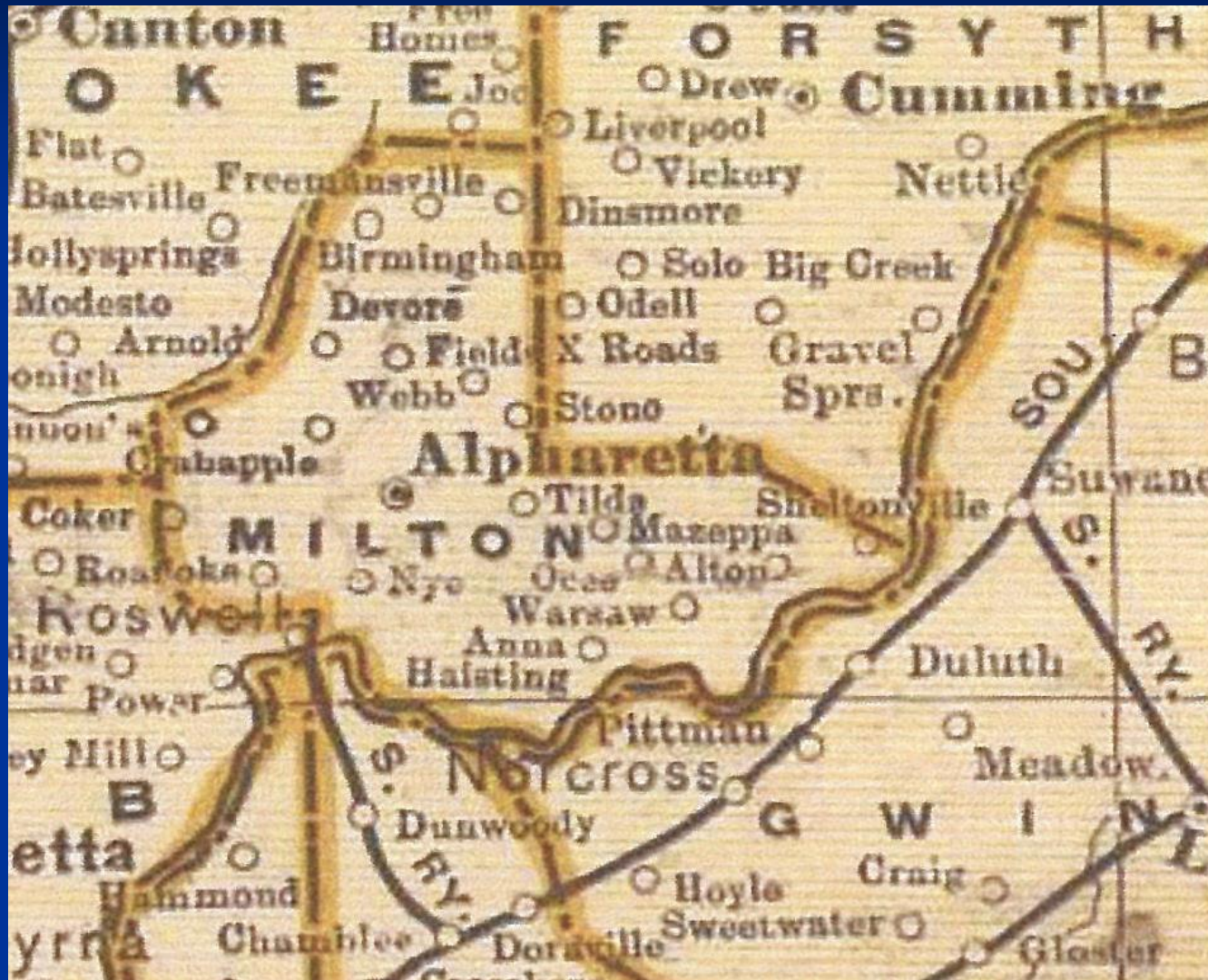

Source: Central of Georgia Railway Map of Alabama and Georgia, 1899

Post Offices West of Ga. 400

- Alpharetta
- Arnold
- Beathoney
- Birmingham
- Coker
- Crossville
- Devore
- Dinsmore
- Dow
- Field's Crossroads
- Free Soil/ Freemansville
- Gopher
- Lebanon
- Roanoke
- Roswell
- Social Hill

Future Research

- Continue to work with Connie Mashburn, Alpharetta and Old Milton County Historical Society to complete a description of all Post Offices in Milton County
- Create sequential maps to appear and disappear by year
- Study genealogy of Post Masters & their families
- Analyze U.S. Census data to build a profile of community residents around post offices

Join us! Become involved in a project!

1887 Henry Gannett Map

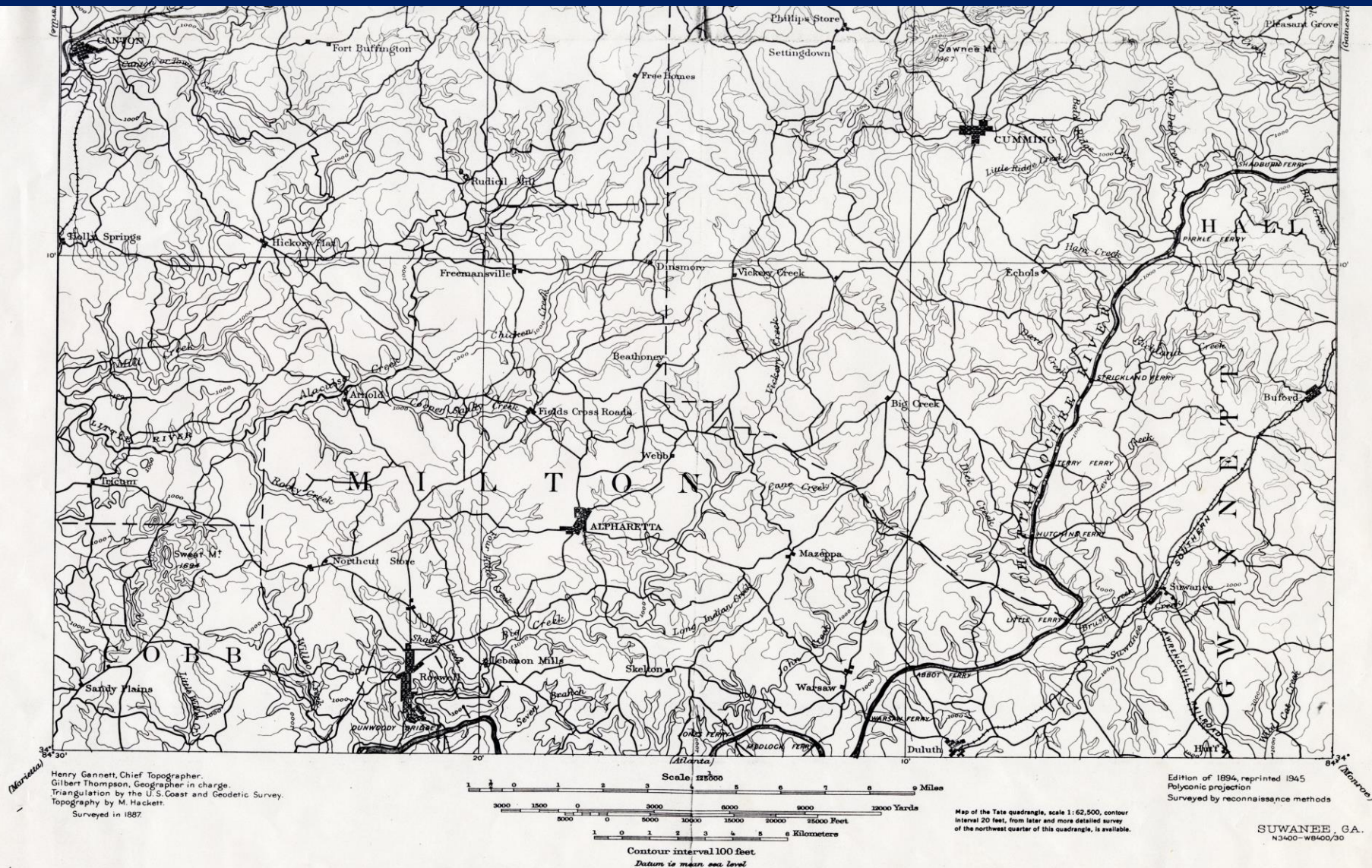

Tilda

master at which office will be paid by the Department.

You should inform the contractor, or person performing service for him, of this application, and require him to execute the inclosed certificate as to the practicability of supplying the proposed office with mail, and return the same to the Department.

Very respectfully,

E. G. R. [Signature]
Fourth Asst Postmaster General

To Mr.

Jackson Morton

care of the Postmaster of

Ocee

who will please forward to him.

STATEMENT.

The proposed office to be called

Tilda or Elkhead Creek

Select a short name for the proposed office, which, when written, will not resemble the name of any other post office in the State.

It will be situated in the quarter of Section Township (North or South),
Range (East or West), in the County of *Milton* State of *Pa*
It will be on ~~some~~ route No. *21220* being the route from *Alpharetta*
to *Scranton* on which the mail is now carried times per week.
Will it be directly on this route?—*Yes*
If not, how far from it?—*Yes*
If not on any route, is a "Special Office" wanted?—*Yes* To be supplied from
The name of the nearest office to the proposed one, on one side, is *Ocee*
its distance is *2 1/2* miles in a *West East* direction from the proposed office.
The name of the nearest office, on the other side, is *Alpharetta*
its distance is *2 1/2* miles in a *West East* direction from the proposed office.
The name of the other nearest office to the proposed one is *Scranton*
its distance by the most direct road is *Three* miles in a *North* direction from the proposed office.
The name of the most prominent river near it is *Chatahochee*
The name of the nearest creek is *Wichard Creek*
The proposed office will be *six* miles from said river, on the *West side*
side of it, and will be *one half* miles from said nearest creek, on the *East side* side of it.
The name of the nearest railroad is *Wilson*
If on the line of or near a railroad, on which side will the office be located; how far from the track; and what is, or will be, the
name of the station?—*Not on near railroad*
If it be a village, state the number of inhabitants.—*Not a village*
Also, the population to be supplied by the proposed office.—*Wagon Wheel 1000 300*

er the inquiries fully and accurately, or the case will not be acted upon.

Applications for post offices should be accompanied by petitions of the

Stono
(not Clio)

(No. 1011—NEW SERIES—JULY 1, 1889.)

(LOCATION PAPER.)



Post Office Department,

OFFICE OF THE FIRST ASSISTANT P. M. GENERAL,

Washington, D. C., Aug 21, 1889

Sir: Before the Postmaster General decides upon the application for the establishment of a post office at Clio, County of Milton Fulton

State of Ga., it will be necessary for you to carefully answer the subjoined questions, get a neighboring postmaster to certify to the correctness of the answers, and return the location paper to the Department addressed to me. If the site selected for the proposed office should not be on any mail route now under contract, only a "Special Office" can be established there, to be supplied with mail from some convenient point on the nearest mail route by a special carrier, for which service a sum equal to two-thirds of the amount of the salary of the postmaster at such office will be paid by the Department.

You should inform the contractor, or person performing service for him, of this application, and require him to execute the inclosed certificate as to the practicability of supplying the proposed office with mail, and return the same to the Department.

Very respectfully,

J. S. Blackman
First Ass't Postmaster General.

To Mr. Jas. M. Dadds, Jr.
care of the Postmaster of Magee

STATEMENT.

The proposed office to be called Clio Stono.

Select a short name for the proposed office, which, when written, will not resemble the name of any other post office in the State.

It will be situated in the North Eastern part of Milton Co. South know the section
about 1/2 mile from the Dorsey Co. line. Township No Town (North or South), Range (East or West), in the County of Milton

State of Georgia

It will be on or near route No. Dont know the number
to Alpharetta, being the route from Duluth

and accurately, or the case will not be acted upon.

Applications for post offices must be accompanied by a certificate from a neighboring postmaster.