

# Marriott's Grand Hotel

Scenic Highway 98  
Point Clear, Alabama 36564  
(205) 928-9201

- |   |   |
|---|---|
| <input type="checkbox"/> 308 guest rooms  | <input type="checkbox"/> Activities desk                          |
| <input type="checkbox"/> 21 suites/parlors  | <input type="checkbox"/> Charter yachts                           |
| <input type="checkbox"/> 8 cottages   | <input type="checkbox"/> Sauna and whirlpool                      |
| <input type="checkbox"/> 10,000-square-foot-ballroom, divisible into 2 sections   | <input type="checkbox"/> Horseback riding                         |
| <input type="checkbox"/> <i>Grand Dining Room</i> features live music and dancing | <input type="checkbox"/> Children's activity programs (in season) |
| <input type="checkbox"/> Two 18-hole championship golf courses and club house     | <input type="checkbox"/> Fishing                                  |
| <input type="checkbox"/> 10 rubico-surfaced tennis courts                         | <input type="checkbox"/> Jogging trails                           |
|   | <input type="checkbox"/> Children's playground and game room      |
|   | <input type="checkbox"/> 24-hour room service                     |
|   | <input type="checkbox"/> Paddleboats                              |

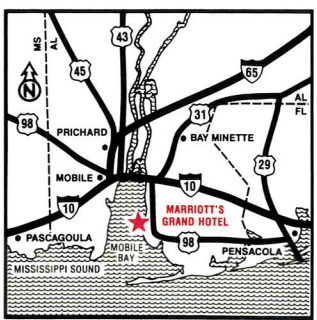

**Directions from Mobile Airport:**  
East on Airport Blvd. Take I-65 South to I-10 East. Take I-10 East to Alt. 98. Take Alt. 98 to Scenic 98 (in Fairhope). Continue on to Marriott's Grand Hotel.

For reservations at Marriott Hotels and Resorts call toll free, in the United States and Canada, 800-228-9290.

**Marriott Sales Offices**  
Chicago 312-318-0500, Telex 286998—Los Angeles 213-641-8702, Telex 9103286529—New York (New York City) 212-603-8200, Telex 82908 (Norwalk, CT) 203-854-4400, Fax 203-855-8446—Washington, D.C. 703-442-0440, Telex 824421—Frankfurt 49-069-253041, Telex 041629—London 44-01-434-2299, Telex 266190—Mexico City 905-533-4060, Telex 001771195—Miami-Latin American Sales 305-649-5000, Telex 514804—Sydney 61 toll-free 008-251259, Local (02) 357-3027, Telex 127638 FLTDEL—Tokyo 81-03-215-7285, Telex J23376

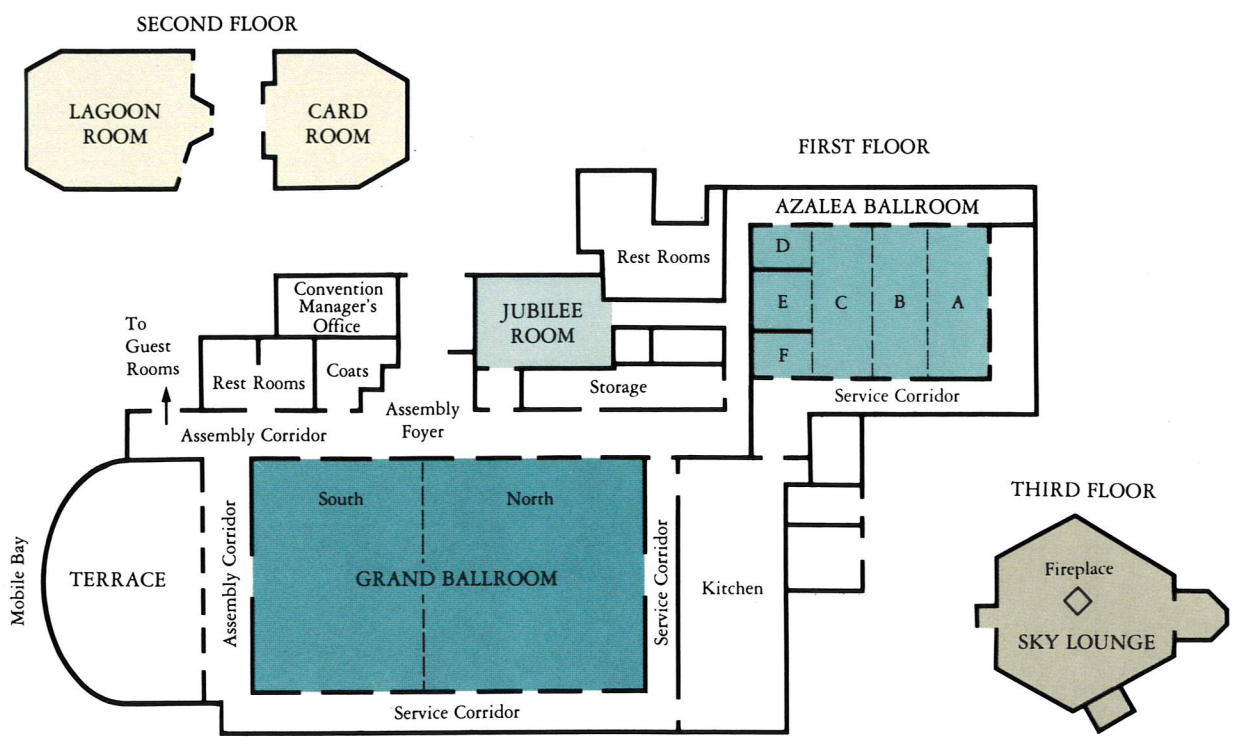

Meeting Room	Dimensions (WxLxH)	Square Footage	Capacity					
			Theater	School-room	Con-ference	U-Shape	Recep-tion	Banquet
Grand Ballroom (North & South)	130x75x14	10,000	1,000	500	N/A	N/A	800	800
Azalea Ballroom	100x50x15	5,000	390	310	N/A	N/A	360	360
Salon A	27x50x16	1,350	100	80	36	40	75	96
Salons B & C (each)	28x50x16	1,400	100	80	36	50	90	96
Salons D & F (each)	22x17x16	374	15	12	10	10	20	12
Salon E	22x16x16	352	15	12	10	10	20	12
Jubilee Room	45x35x10	1,575	130	80	36	35	100	100
Lagoon Room	51x46x12	2,346	250	120	50	55	250	180
Card Room	30x27x10	810	50	32	20	15	40	48
Sky Lounge*			100	48	30	35	250	240
Boardrooms 1 & 2 (each)	30x12.6x10	378			20			

\*Sky Lounge has fireplace in center.  
18 outdoor areas available for catered events.