

AN ARCHAEOLOGICAL AND HISTORICAL  
SURVEY OF THE WILLIAMSON PROPERTY,  
COLLIER COUNTY, FLORIDA

for

Coastal Engineering Consultants, Inc.

By Robert S. Carr

August, 1989

AN ARCHAEOLOGICAL AND HISTORICAL SURVEY  
OF PART OF THE WILLIAMSON PROPERTY,  
COLLIER COUNTY, FLORIDA

By  
Robert S. Carr  
Archaeological Consultant

Conducted  
For  
Todd Turrell  
Coastal Engineering Consultants, Inc.

August 1989

AN ARCHAEOLOGICAL AND HISTORICAL SURVEY  
OF PART OF THE WILLIAMSON PROPERTY,  
COLLIER COUNTY, FLORIDA

By

Robert S. Carr  
Archaeological Consultant

This survey was conducted regarding potential impact to historic resources in response to questions for an environmental impact statement being prepared by project consultant, Todd Turrell. Field work was done on July 22-23, 1989 with the assistance of archaeological technician, Jorge Zamamillo.

The project area is located within part of Section 31, T. 46 S., R. 29 E and part of Section 6, T. 47 S., R. 29 E. (Figure 1) west of Immokalee in Collier County. The project area boundary was indicated on an aerial photograph (Sheet 207 C) provided by Mr. Turrell. The boundary on the north is Lake Trafford Road, on the east on the section line, on the south along the existing tree line of the mixed swamp forest (indicated by barb wire fence line), and on the west along an unnamed creek.

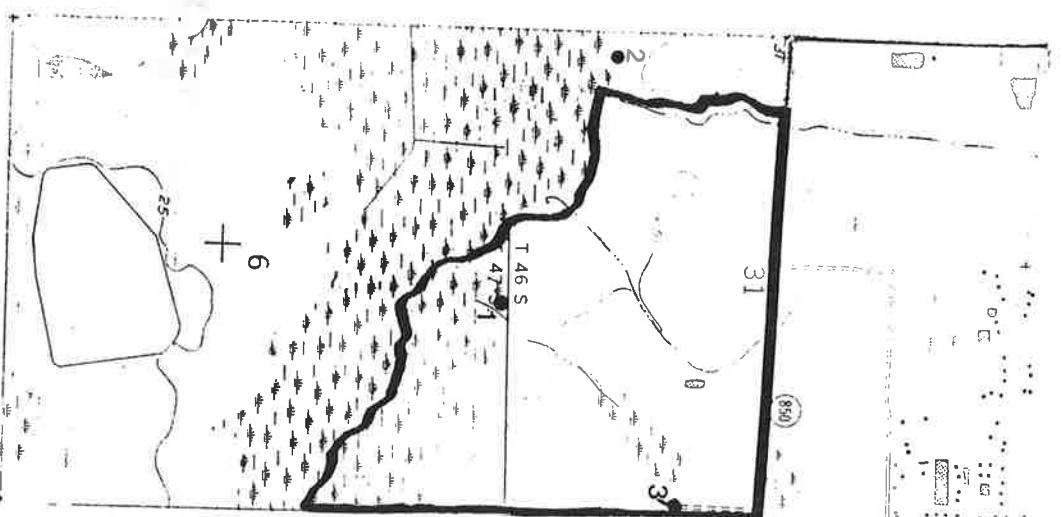

FIGURE 1:

## WILLIAMSON PROJECT AREA

1. Williamson Mound #1 CR 703
2. Williamson Site #2 CR 704
3. Old Wooden Structure