

ALBIN 28

TOURNAMENT EXPRESS

TECHNICAL SPECIFICATIONS BULLETIN

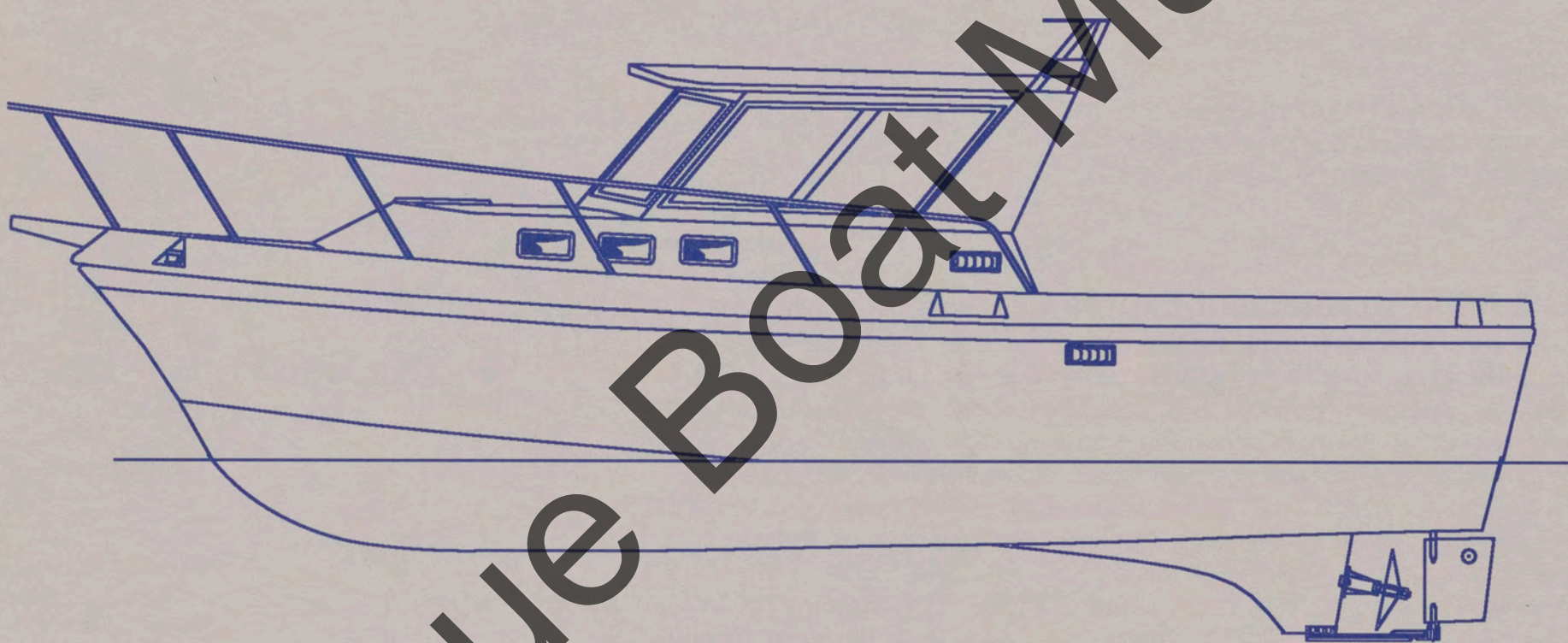

TECHNICAL SPECIFICATIONS

L.O.A (Standard Pulpit)	29' 11"
Length (Hull & Deck Only)	28' 04"
Length O. A.(Pulpit &Swim Platform)	31' 04"
L.W.L.	24' 00"
Beam O. A.(complete with Rub Rail)	10' 00"
Draft	3' 02"
Deadrise at Transom	16°
Air Draft (Complete with Radar Arch) ^{(1)(FD)}	8' 06"
Air Draft (To Wheelhouse Top w/o Arch) ^{(2)(FD)}	7' 10"
Air Draft (Convertible, Top of Windshield) ^(FD)	6' 09"
Air Draft (Convertible, Top of Windshield + Arch) ^(FD)	7' 09"
Water Capacity (Including Water Heater)	36 gals.
Fuel Capacity ⁽³⁾	132 gals.
Displacement, Loaded	7,500 lbs.
Hull Type	Progressive Modified -V
Speed Range ⁽⁴⁾	20 - 30+knots

THE 28 TE Flush Deck Option

gives extra space to the cockpit. The engine is moved forward under the wheel house. We have raised the deck 4" in the wheel house. The aft double berth is now a 32" wide single, but gains 4" of height. There is a extremely large well for storage in the engine's place. The whole well can be hydraulically raised for access. The Flush Deck is now a straight drive. "T" hatch for better access to steering and tanks. There is a chart box option for port. Helm seat and pedestal are removable for better access to motor and there is service access from aft berth area.

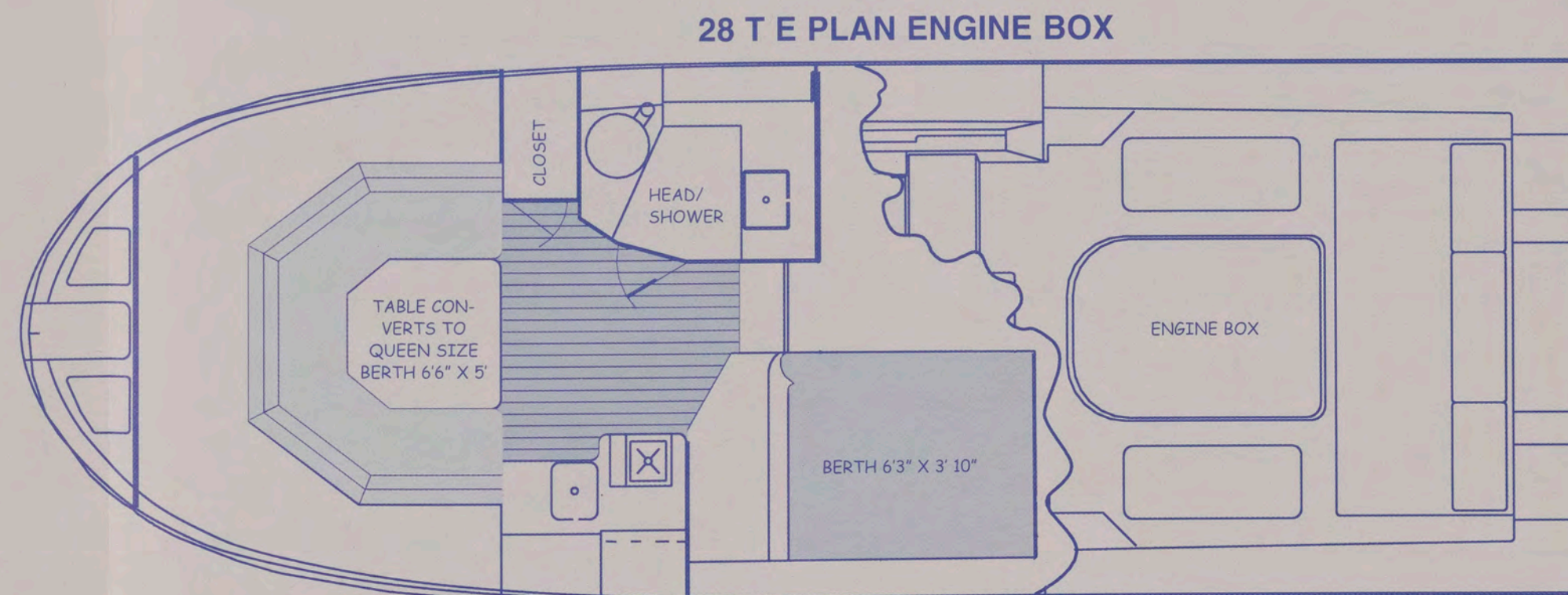
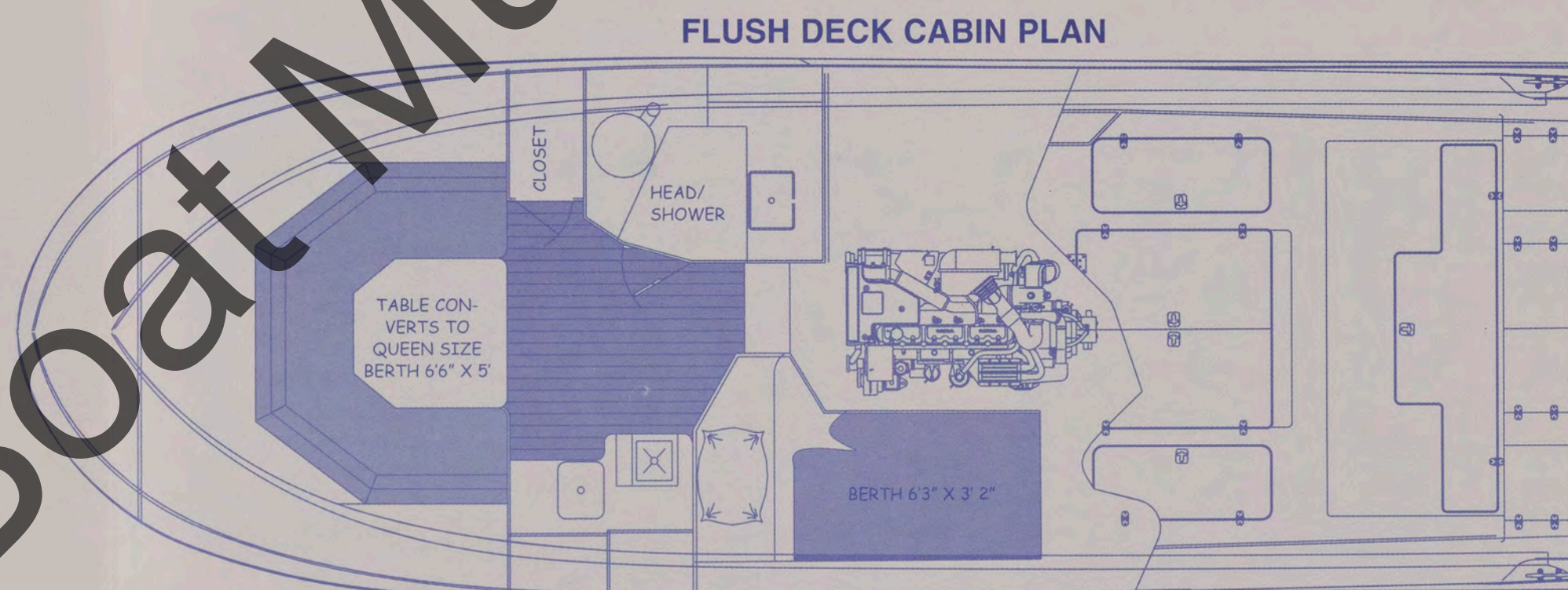
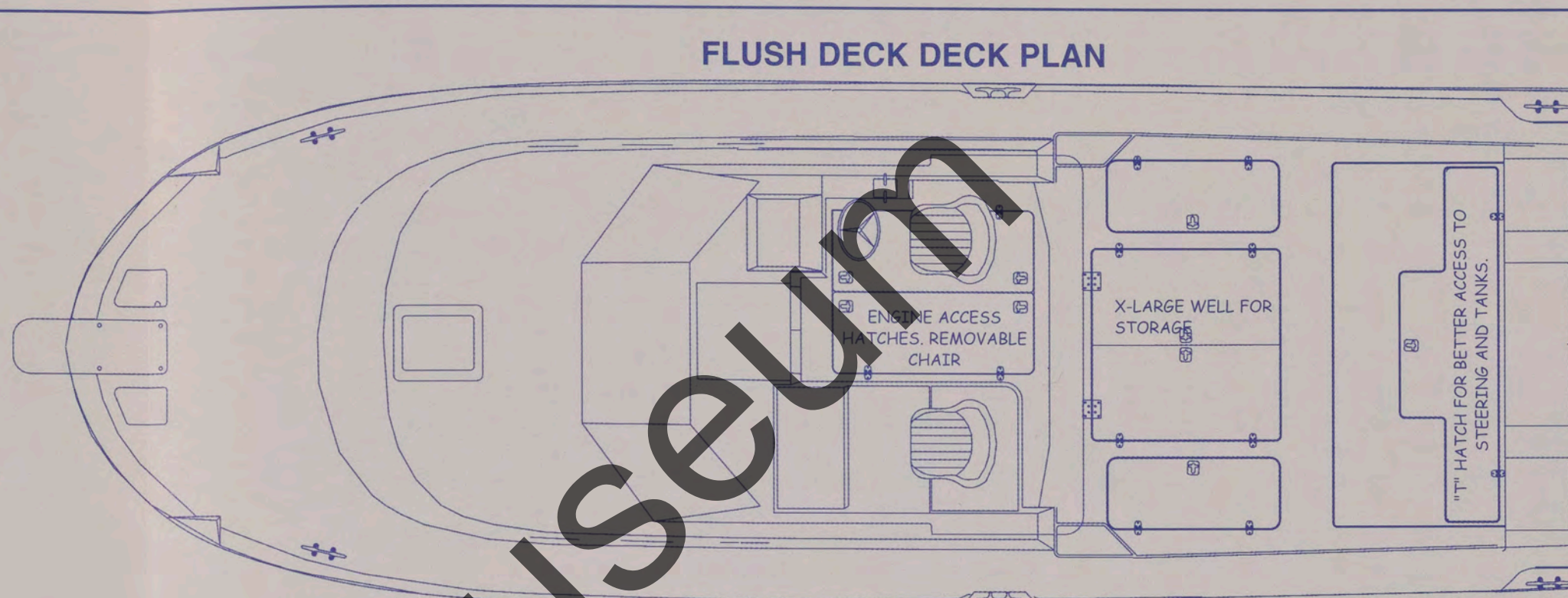

- (1) Add Radar & Rod Holders etc.
- (2) Arch is Removable
- (3) 60 gals. Additional Fuel Available
- (4) Varies with layout and engine choice.
- (FD) Add 6 1/2" to Height on Air Draft

The 28 Albin Tournament Express is designed to satisfy the exacting demands of the offshore/inshore fishermen. This boat also incorporates comforts normally expected for a family weekend on the water, features appealing to the fisherman include wide side decks, large cockpit, rod storage racks, sink with chopping board, rod holders, and tackle drawers. The forward cabin area has an enclosed marine head/shower compartment, a convertible dinette and a galley area with stove, refrigerator, microwave and sink. Aft of the galley is a 6' 3" X3' 10" berth (Flush Deck aft berth width is 3' 3"). Eight opening portholes and overhead hatch provide excellent ventilation to this area. The hull is designed with the North Sea in mind. The skeg protects the propeller and adds to the stability. The bow flair keeps the decks dryer. With its standard bow thruster for dock side maneuvering and Power Boat Reports' observation as "the finest tracking boat of any size tested to date" has earned the Albin 28 the reputation of one of the finest all weather boats of its size. The boat can be ordered with or without the engine box as a Flush Deck. It can also be ordered with a wheelhouse or as a convertible.

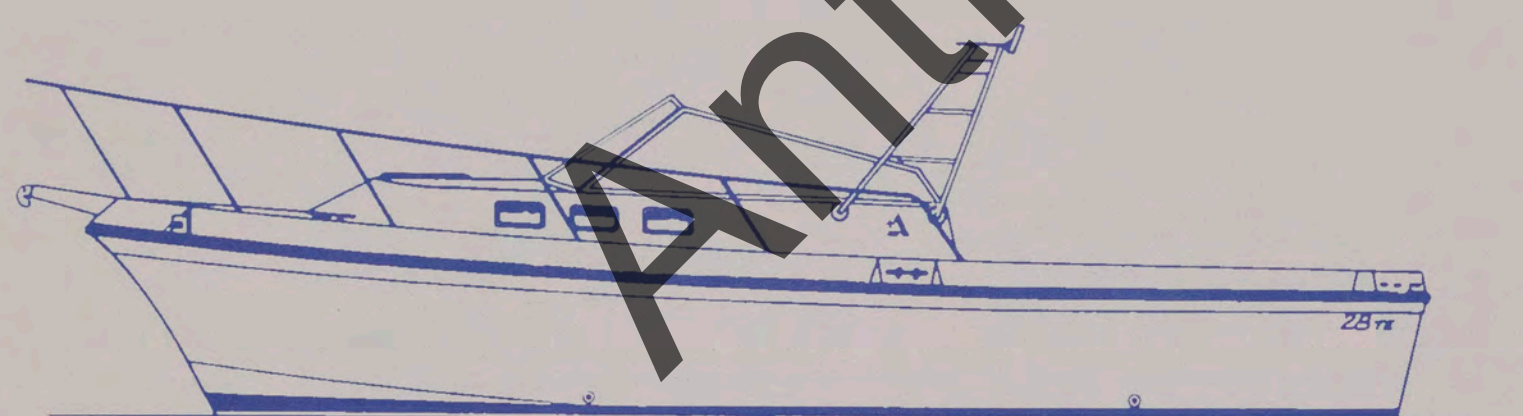

CONVERTIBLE OPTION

STANDARD EQUIPMENT LIST

The Albin 28 Tournament Express has been designed to give a soft and stable ride in heavy sea conditions coupled with very economical fuel consumption. The Albin 28 is uniquely designed to meet the demands of the professional fisherman as well as providing accommodations and creature comforts to suit the needs of the cruising family. A rugged, individualized offshore vessel, the Albin 28 is built without compromise. Available with an engine box or as a Flush Deck. Either comes with a wheelhouse or as a convertible

Wheelhouse & Cockpit

Red/White Light in Wheelhouse
Courtesy Lights in Wheelhouse & Cockpit
12v Outlet supplied at Helm station
Custom Electronics area for Flush Mounting Electronics
Hydraulic Steering with Tilt-Wheel
Recessed Rod Storage Port and Stbd Cockpit
Large Storage and Access Hatches in Deck
(4) Rod Holders in Coamings
Large 2-Hatch Fish/ Storage Box in Transom
Oversized Live Bait-Well in Transom
Sliding Helm Seat with Swivel
Navigation Station with Crew Seating
Drawers and Tackle Storage
Pantograph Windshield Wipers (3)
Drink Holders installed in Wheelhouse
Sliding Windows Port and Stbd

Forward Deck Area

Wide, Unobstructed Side Decks
Large Mooring Bit with Bow Pulpit
S/S Extended Bow Rail To Back of Wheelhouse
(6) Large S/S 10" Mooring Cleats
Stainless Steel Horn
(2) Hatches access Anchor Locker
Large opening Hatch in Forward Cabin Roof
(8) Portholes with Screens in Forward Cabin
Grab Rails on Wheelhouse Roof and Sides
Fully Vented Center Windshield
Radar Arch with Antenna and Radar Pads

Mechanical/ Electrical

Bow Thruster with Electronic Control
Hydraulic Steering
Easy Access to Circuit Breaker Panel
Full Engine Instrumentation with Audible Alarms
Dockside 30 AMP Service
Ample 110v Outlets throughout with GFI Protection
Fresh Water Cooled Engine
Large Hatch with Gas Struts for Easy Engine Access
Hydraulic Trim Tabs
30 AMP Battery Charger
Shaft 1.50" Aquamet 22 Stainless Steel
TIDES™ Shaft Seal
Propeller 4 Bladed Nibral
Seacocks & Strainers are Bronze
All Thru-Hull Fittings are Bonded
(3) Electrical Bilge Pumps and (1) Manual Pump

Cabin/ Galley Area

S/S Sink with Pressurized Water System
Hot Water Heater Heated by Engine and 110v
Microwave Oven, 110v
Butane Stove
Refrigerator 12v DC/ 110v AC
Head/ Shower Full Size Marine Toilet w/10 gal Holding Tank w/
dedicated Sump Pump
Accent Lighting in Cabin & Head
Courtesy Lights in Cabin & Head
Ample Drawers, Cupboards and Lockers
Dinette Seating area converts to Queen sized Berth
Double Berth aft of Galley Area (Single in Flush Deck Model)
AM/ FM Stereo CD Player

Upholstery & Carpet

Settee and Berth Cushions feature high-density foam with the
Best Quality "Zip-On" Fabric Covers
Custom Cabin Headliner with Leather-grained Vinyl over insulated
foam backing
Forward Cabin is Carpeted and Color-Matched to interior
Upholstery

Factory Options

Consult your Albin Dealer for complete details on Available factory
installed options or custom work.

Construction

At Albin we use the best available materials for the construction
of our ocean-going vessels.
Deck Hardware is through-bolted using aluminum backing plates.
Hull-to-deck joint is through-bolted and chemically bonded and
sealed using "5200" adhesive.
We construct our boats using a combination of bi-axial & uni-
directional FRP knitted products. All through-hull areas have
solid reinforcement to prevent damage to the Hull/Deck
Laminates.
By the use of these construction techniques, coupled with superi-
or hull and interior designs, we enjoy the enviable reputation of
fine sea-keeping qualities, comfortable and practical interiors with
economy in use.

Specifications subject to change without notice. Please contact
your dealer or Albin Marine.