

# express cruiser

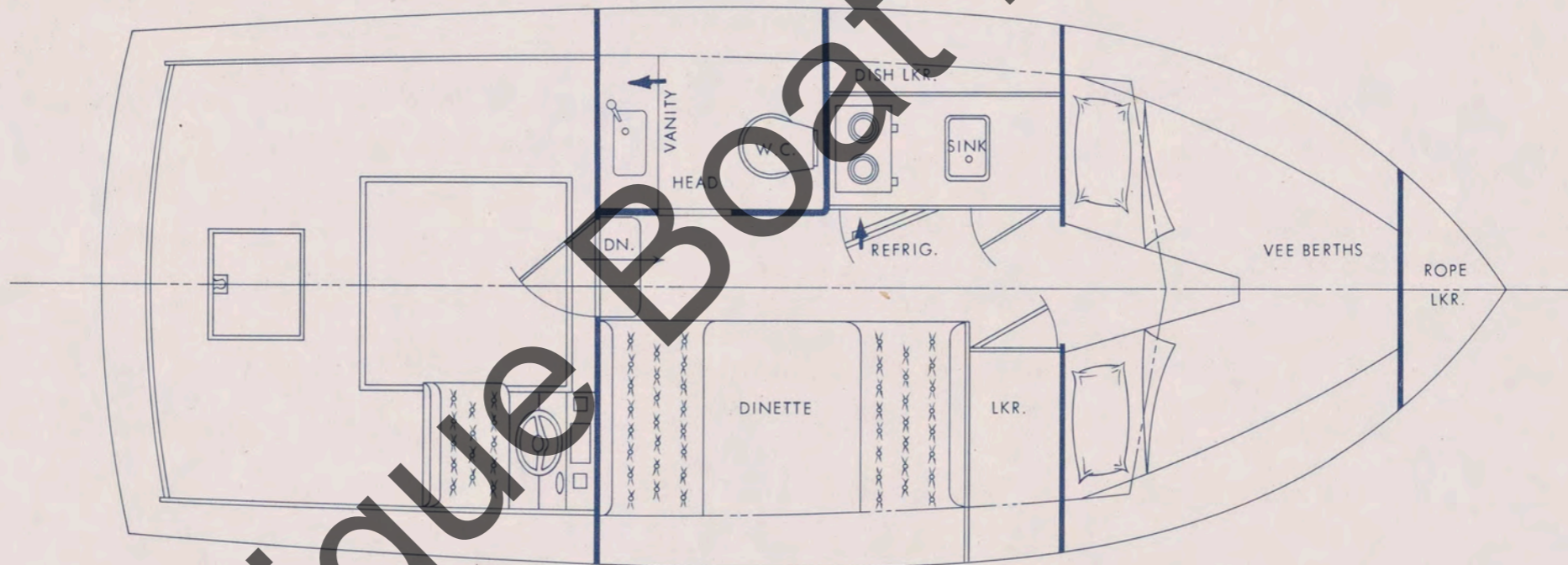
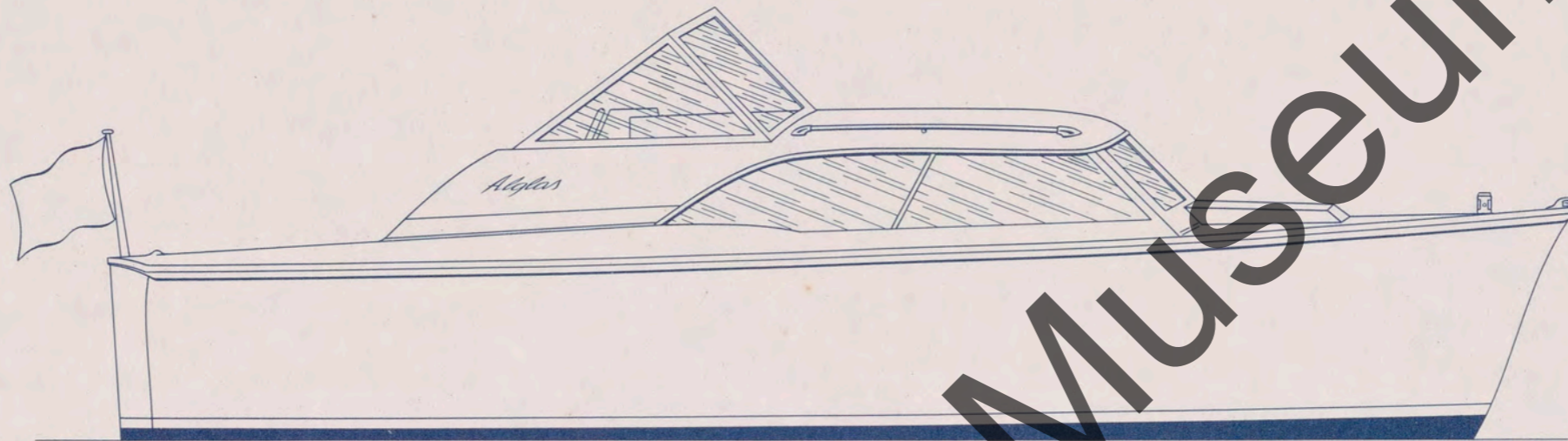

*Alglas* all-weather  
25' Fiberglass Cruisers

ALGLAS CORP., a subsidiary of C. P. Leek & Sons, Inc. / EGG HARBOR CITY, NEW JERSEY

# Alglas 25' express cruiser

## specifications

L. O. A. — 24'5"  
Beam — 9'6"  
Draft — 2'0"  
Freeboard, bow — 3'10"  
Freeboard, stern — 2'10"  
Headroom, forward cabin — 4'8"  
Headroom, trunk cabin — 6'2"  
Weight: Cruiser — 5,450 lbs.  
Height: Waterline to top of trunk cabin — 5'9"  
Waterline to top of cruiser windshield — 7'3"  
Fuel cap.: 72 gal.  
Twin 36-gal. Monel tanks  
Water cap.: 12 gal.  
Stainless steel tank

## design features

Hull design allows easy planing at low speed and permits flush cockpit floor. The deep hull sections provide good propeller and rudder protection. Curved transom gives easier ride in following sea. Molded in spray rails keep boat drier. Sleek looking "sport car" styling used on cabin designs.

## construction materials

### *hull construction:*

One piece molded fiberglass, hand lay-up with high gloss gel coat finish.  
Molded in fir longitudinal stringers.  
Engine beds fir — bolted to stringers.  
Engine hatches of molded fiberglass.

### *decks and pilot house:*

One piece molded fiberglass with high gloss gel coat finish on exterior, teak plastic laminate on interior.

*cockpit:* One piece molded fiberglass with gloss gel coat finish and non-skid pattern molded in cockpit floor.

*interior:* Bulkheads and floor secured to hull with fiberglass bond.

Bulkheads and faces covered with teak plastic laminate.

Hull sides covered with polypropylene carpet.

Floors covered with mylar coated vinyl.

Fire-resistant vinyl upholstery on overhead.

## standard equipment

Berths are vinyl upholstered over foam cushions.

Interior light fixtures.

Galley with Formica top, stainless sink, ice box.  
Stand-up enclosed head.

Dinette with storage space in seats and formica-covered table top — converts to sleep two.

Includes upholstered seats and backs.  
Accoustical insulation in engine compartment.  
Rubber strut bearing.  
Manganese bronze underwater hardware.  
Positive action mechanical steering.  
Electric bilge pump.  
12-Volt electrical system.  
Electric Windshield Wiper.  
Vented windshields.  
Forward hatch (molded fiberglass).  
Slide type side windows, screened. (Cruiser model).  
Cabin door with lock and key.  
All hardware stainless or chrome plated brass.  
Running lights and anchor light.  
Electric horn and bell.  
2½ lb. dry powder type fire extinguisher.  
Two life preservers.  
Anchor with 100 ft. line. Four 25 ft. dock lines.  
Stainless handrails on cabin or pilot house top.  
Stainless rub rail molding.  
Exhaust muffler.  
Convertible navy top and side curtains  
Propellor shaft — 1" bronze

## engine & performance

### Standard 220 HP Pacer

cruise . . . . . 20 knots

top . . . . . 25 knots

Engines are gasoline, custom built for Alglas Corp.

220 HP—4,000 RPM, 327 cu. in., bore 4"  
stroke 3¼", 8 cyl. in 90° Vee.