

LANDMARKS

Dutchess County Landmarks Association, Inc.
P. O. Box 944, Poughkeepsie, New York 12602

BUILDING - STRUCTURE INVENTORY FORM

TOWNSHIP _____ Code
or CITY _____ No. _____

1. BUILDING NAME Augustus & Lena Day

2. VILLAGE or HAMLET Red Hook

3. STREET or ROAD 3 Graves St.

4. OWNERSHIP: Public _____ Private ☒

5a. PRESENT OWNER Augustus & Lena Day

Mailing Address 3 Graves St.
Red Hook, New York

Deed Recorded: Liber _____ Page _____

5b. PRESENT OCCUPANT Augustus & Lena Day

Mailing Address 3 Graves St.
Red Hook, NY

5c. FORMER OWNERS

Name

Dates of
Ownership

Deed Recorded
Liber Page

6. USES
Present _____

Schuttel

7. ACCESSIBILITY TO PUBLIC: Exterior visible from public road: Yes ☒ No _____
Interior accessible: Explain RESIDENTIAL

8. BUILDING MATERIAL: clapboard ☒ stone _____ brick _____
board and batten _____ shingles _____ stucco _____ other _____

9. STRUCTURAL SYSTEM: a. wood frame with interlocking joints (post and beam) ☒
b. wood frame with light members (balloon frame) _____ c. masonry load bearing walls _____
d. metal (explain) _____ e. other _____

10. CONDITION: excellent _____ good ☒ fair _____ deteriorated _____

11. INTEGRITY: Original site ☒ If moved, when and from where _____
List major alterations and dates:

Fire in 1937 When re-tored - roof was raised -

12. ROOF: a. gable _____ saltbox _____ gambrel _____ hip _____ mansard _____ other _____ dormers _____
b. wood shingles _____ asphalt shingles _____ slate _____ metal _____ other _____

14. THREATS TO BUILDING: none known ☒ zoning _____ roads _____ developers _____ deterioration _____
other _____

15. RELATED OUTBUILDINGS AND PROPERTY: size of lot _____ acreage _____ barn _____
carriage house _____ garage _____ privy _____ shed _____ greenhouse _____ shop _____ gardens _____
landscape features good other _____

16. SURROUNDINGS OF BUILDING: open land _____ woodland _____ scattered buildings _____ residential ☒
densely built-up _____ commercial _____ industrial _____ other _____

13. MAP

North



17. INTERRELATIONSHIP OF BUILDING AND SURROUNDINGS:

If structure is in an historic district, name district. _____

18. OTHER NOTABLE FEATURES OF THE BUILDING AND SITE: (Include interior features if known)

19. INITIAL CONSTRUCTION:

Date about 100 yrs. ago Architect _____ Builder _____

SIGNIFICANT ALTERATIONS:

Date _____ Architect _____ Builder _____

20. ARCHITECTURE: (Indicate period or style if known)

Pre-Revolutionary _____ Federal _____ Greek Revival _____ Victorian _____ Other _____

20a. HISTORICAL INFORMATION AND TRADITIONS:

21. SOURCES:

Maps: (List name of owner as shown on map and School District where applicable)

1850 Dutchess Co. _____ 1858 Dutchess Co. _____

1867 Atlas _____ School District No. _____

1876 Atlas _____ School District No. _____

Location of
early photographs: _____

Inventory by

Address

Mrs. Lloyd Hapeman
11 Park Ave
Red Hook, NY

Date

Tel.

5/5/75
8-1551

BUILDING-STRUCTURE INVENTORY FORM

DIVISION FOR HISTORIC PRESERVATION
NEW YORK STATE PARKS AND RECREATION
ALBANY, NEW YORK (518) 474-0479

FOR OFFICE USE ONLY

UNIQUE SITE NO. _____
QUAD _____
SERIES _____
NEG. NO. _____

YOUR NAME: Mrs. Lloyd Hapeman DATE: 5/5/75

YOUR ADDRESS: 11 PARK Ave Red Hook TELEPHONE: 758-1551

ORGANIZATION (if any): LANDMARKS

IDENTIFICATION

1. BUILDING NAME(S): Gus and Lena Day
2. COUNTY: Dutchess TOWN/CITY: Red Hook VILLAGE: Red Hook
3. STREET LOCATION: 3 Graves Street
4. OWNERSHIP: a. public ☐ b. private ☒
5. PRESENT OWNER: Gus and Lena Day ADDRESS: 3 Graves St.
6. USE: Original: _____ Present: RESIDENTIAL
7. ACCESSIBILITY TO PUBLIC: Exterior visible from public road: Yes ☒ No ☐
Interior accessible: Explain Lived in

DESCRIPTION

8. BUILDING MATERIAL: a. clapboard ☒ b. stone ☐ c. brick ☐ d. board and batten ☐
e. cobblestone ☐ f. shingles ☐ g. stucco ☐ other: _____
9. STRUCTURAL SYSTEM: a. wood frame with interlocking joints ☒
(if known) b. wood frame with light members ☐
c. masonry load bearing walls ☐
d. metal (explain) _____
e. other _____
10. CONDITION: a. excellent ☐ b. good ☒ c. fair ☐ d. deteriorated ☐
11. INTEGRITY: a. original site ☒ b. moved ☐ if so, when? _____
c. list major alterations and dates (if known): _____

House over 100 yrs. old. In 1937, fire did some damage - Roof was raised when rebuilt -

12. PHOTO:

13. MAP:

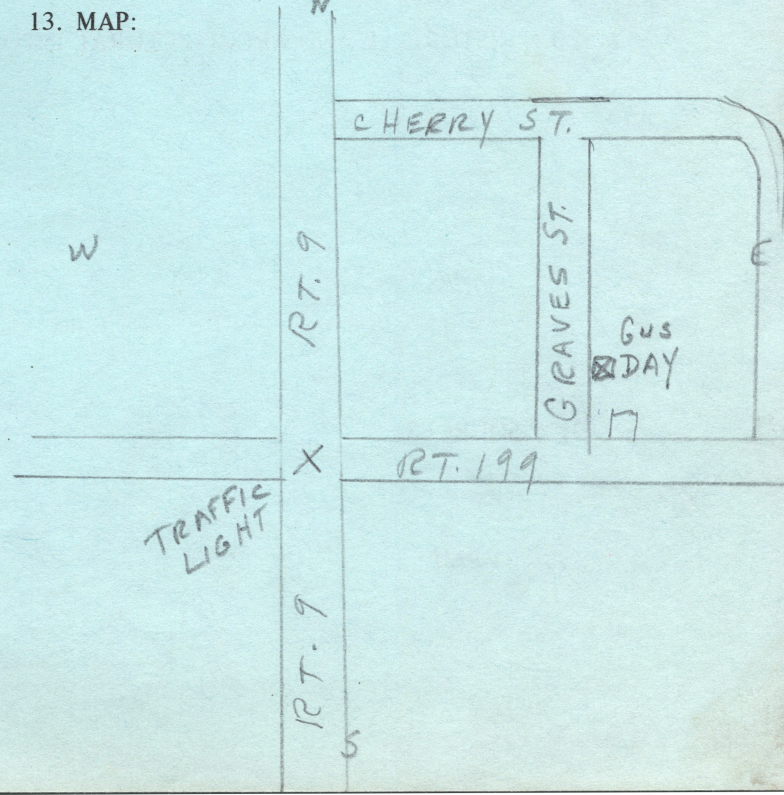

14. THREATS TO BUILDING: a. none known ☒ b. zoning ☐ c. roads ☐
d. developers ☐ e. deterioration ☐
f. other: _____
15. RELATED OUTBUILDINGS AND PROPERTY:
a. barn ☐ b. carriage house ☐ c. garage ☐
d. privy ☐ e. shed ☐ f. greenhouse ☐
g. shop ☐ h. gardens ☒
i. landscape features: good - Lawn - Driveway
j. other: _____
16. SURROUNDINGS OF THE BUILDING (check more than one if necessary):
a. open land ☐ b. woodland ☐
c. scattered buildings ☐
d. densely built-up ☐ e. commercial ☐
f. industrial ☐ g. residential ☒
h. other: _____

17. INTERRELATIONSHIP OF BUILDING AND SURROUNDINGS:
(Indicate if building or structure is in an historic district)

in original days a paint shop was on property.

18. OTHER NOTABLE FEATURES OF BUILDING AND SITE (including interior features if known):

SIGNIFICANCE

19. DATE OF INITIAL CONSTRUCTION: over 100 yrs. ago

ARCHITECT: _____

BUILDER: _____

20. HISTORICAL AND ARCHITECTURAL IMPORTANCE:

21. SOURCES:

22. THEME: