

LANDMARKS

Dutchess County Landmarks Association, Inc.
P. O. Box 944, Poughkeepsie, New York 12602

BUILDING - STRUCTURE INVENTORY FORM

TOWNSHIP _____ Code
or CITY _____ No. _____

1. BUILDING
NAME _____

2. VILLAGE
or HAMLET _____

3. STREET
or ROAD _____

4. OWNERSHIP: Public _____ Private ☒

5a. PRESENT OWNER Mr. Julian Hook

Mailing Address 35 Church St.
Red Hook, N.Y.

Deed Recorded: Liber _____ Page _____

5b. PRESENT OCCUPANT Same as above

Mailing Address _____

5c. FORMER OWNERS

Name	Dates of Ownership	Deed Recorded Liber	Page
<u>Edward Teator sold to Julian Hook on</u>	<u>May 30 1927</u>	<u>1,332</u>	<u>637</u>
<u>Newton Rhodes sold to Ed Teator on</u>	<u>Aug 21 1947</u>	<u>670</u>	<u>61</u>
<u>Evelyn sold Newton Rhodes on</u>	<u>April 10 1945</u>	<u>624</u>	<u>47</u>

7. ACCESSIBILITY TO PUBLIC: Exterior visible from public road: Yes ☒ No _____
Interior accessible: Explain Private

8. BUILDING MATERIAL: clapboard _____ stone ☒ brick _____
board and batten _____ shingles _____ stucco _____ other _____

9. STRUCTURAL SYSTEM: a. wood frame with interlocking joints (post and beam) ☒
b. wood frame with light members (balloon frame) _____ c. masonry load bearing walls _____
d. metal (explain) _____ e. other _____

10. CONDITION: excellent _____ good ☒ fair _____ deteriorated _____

11. INTEGRITY: Original site _____ If moved, when and from where _____
List major alterations and dates: _____

12. ROOF: a. gable _____ saltbox _____ gambrel _____ hip _____ mansard _____ other _____ dormers _____
b. wood shingles _____ asphalt shingles ☒ slate _____ metal _____ other sloped roof

14. THREATS TO BUILDING: none known ☒ zoning _____ roads _____ developers _____ deterioration _____
other _____

15. RELATED OUTBUILDINGS AND PROPERTY: size of lot _____ acreage _____ barn _____
carriage house _____ garage _____ privy _____ shed _____ greenhouse _____ shop _____ gardens _____
landscape features _____ other Stone well

16. SURROUNDINGS OF BUILDING: open land _____ woodland _____ scattered buildings _____ residential ☒
densely built-up _____ commercial _____ industrial _____ other _____

13. MAP

North

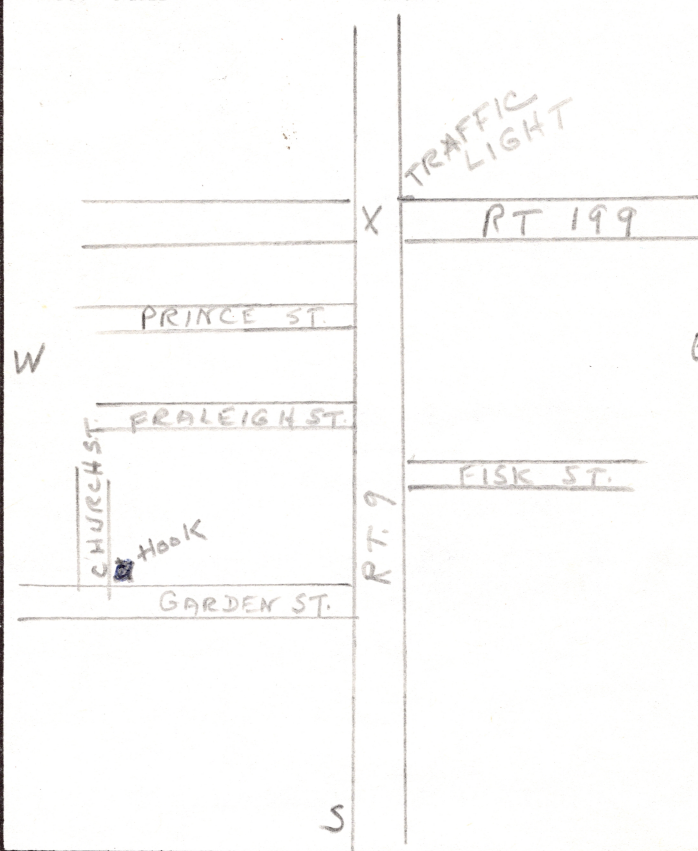

17. INTERRELATIONSHIP OF BUILDING AND SURROUNDINGS:

If structure is in an historic district, name district. _____

18. OTHER NOTABLE FEATURES OF THE BUILDING AND SITE: (Include interior features if known)

19. INITIAL CONSTRUCTION:

Date _____ Architect _____ Builder _____

SIGNIFICANT ALTERATIONS:

Date _____ Architect _____ Builder _____

20. ARCHITECTURE: (Indicate period or style if known)

Pre-Revolutionary _____ Federal _____ Greek Revival _____ Victorian _____ Other _____

20a. HISTORICAL INFORMATION AND TRADITIONS:

Mr. Hook is restoring the house and researching historical data concerning his home. He gave me all the information concerning deeds on front Page.

21. SOURCES:

Maps: (List name of owner as shown on map and School District where applicable)

1850 Dutchess Co. _____ 1858 Dutchess Co. _____

1867 Atlas _____ School District No. _____

1876 Atlas ☒ _____ School District No. _____

Location of early photographs: _____

Inventory by Edythe C. Budd

Address P.O. B. 143

Red Hook, N.Y.

Date PL 8-8090
Tel. May 19, 1975

BUILDING-STRUCTURE INVENTORY FORM

DIVISION FOR HISTORIC PRESERVATION
NEW YORK STATE PARKS AND RECREATION
ALBANY, NEW YORK (518) 474-0479

FOR OFFICE USE ONLY

UNIQUE SITE NO. _____
QUAD _____
SERIES _____
NEG. NO. _____

YOUR NAME: Edythe C. Budd DATE: May 19, 1975
YOUR ADDRESS: P.O. B143 Red Hook TELEPHONE: P4 8-8090
ORGANIZATION (if any): _____

IDENTIFICATION

1. BUILDING NAME(S): _____
2. COUNTY: Dutchess TOWN/CITY: _____ VILLAGE: Red Hook
3. STREET LOCATION: 35 Church St
4. OWNERSHIP: a. public ☐ b. private ☒
5. PRESENT OWNER: Hook Julian ADDRESS: 35 Church St
6. USE: Original: Private home Present: Private home
7. ACCESSIBILITY TO PUBLIC: Exterior visible from public road: Yes ☒ No ☐
Interior accessible: Explain Private

DESCRIPTION

8. BUILDING MATERIAL: a. clapboard ☐ b. stone ☒ c. brick ☐ d. board and batten ☐
e. cobblestone ☐ f. shingles ☐ g. stucco ☐ other: _____
9. STRUCTURAL SYSTEM: a. wood frame with interlocking joints ☒
(if known) b. wood frame with light members ☐
c. masonry load bearing walls ☐
d. metal (explain) _____
e. other _____
10. CONDITION: a. excellent ☐ b. good ☒ c. fair ☐ d. deteriorated ☐
11. INTEGRITY: a. original site ☐ b. moved ☐ if so, when? _____
c. list major alterations and dates (if known): _____

12. PHOTO:

13. MAP:

N

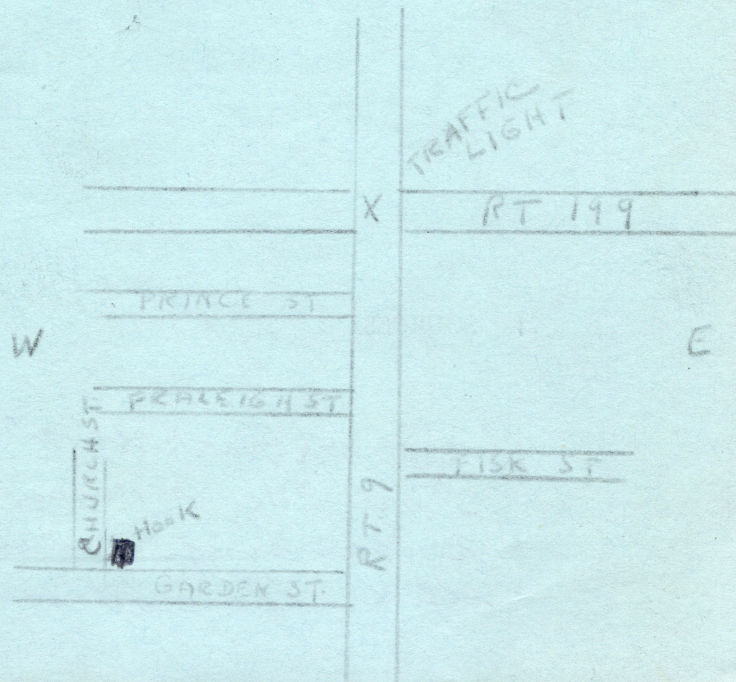

14. THREATS TO BUILDING: a. none known ☒ b. zoning ☐ c. roads ☐
d. developers ☐ e. deterioration ☐
f. other: _____
15. RELATED OUTBUILDINGS AND PROPERTY:
a. barn ☐ b. carriage house ☐ c. garage ☐
d. privy ☐ e. shed ☐ f. greenhouse ☐
g. shop ☐ h. gardens ☐ *stone well.*
i. landscape features: _____
j. other: _____
16. SURROUNDINGS OF THE BUILDING (check more than one if necessary):
a. open land ☐ b. woodland ☐
c. scattered buildings ☐
d. densely built-up ☐ e. commercial ☐
f. industrial ☐ g. residential ☒
h. other: _____
17. INTERRELATIONSHIP OF BUILDING AND SURROUNDINGS:
(Indicate if building or structure is in an historic district)
18. OTHER NOTABLE FEATURES OF BUILDING AND SITE (including interior features if known):

SIGNIFICANCE

19. DATE OF INITIAL CONSTRUCTION: _____
ARCHITECT: _____
BUILDER: _____
20. HISTORICAL AND ARCHITECTURAL IMPORTANCE:
21. SOURCES:

22. THEME: *Mr. Hook is attempting to restore his home. He is researching information pertaining to his home & gave me all the deed information.*