

# LANDMARKS

Dutchess County Landmarks Association, Inc.  
P. O. Box 944, Poughkeepsie, New York 12602

## BUILDING - STRUCTURE INVENTORY FORM

TOWNSHIP or CITY Red Hook Code No. \_\_\_\_\_

1. BUILDING NAME \_\_\_\_\_

2. VILLAGE or HAMLET Red Hook

3. STREET or ROAD West Market St.

4. OWNERSHIP: Public \_\_\_\_\_ Private X

5a. PRESENT OWNER Helen A Coon

Mailing Address 46 West Market St

Deed Recorded: Liber 1332 Page 14

5b. PRESENT OCCUPANT Helen Coon, Scarth family

Mailing Address Same

### 5c. FORMER OWNERS

Name William + Helen Coon Dates of Ownership 1959 -

Deed Recorded Liber \_\_\_\_\_ Page \_\_\_\_\_

6. USES Present home

7. ACCESSIBILITY TO PUBLIC: Exterior visible from public road: Yes X No \_\_\_\_\_  
Interior accessible: Explain \_\_\_\_\_

8. BUILDING MATERIAL: clapboard X stone \_\_\_\_\_ brick \_\_\_\_\_  
board and batten orig shingles \_\_\_\_\_ stucco \_\_\_\_\_ other alum. siding over cl.

9. STRUCTURAL SYSTEM: a. wood frame with interlocking joints (post and beam) \_\_\_\_\_  
b. wood frame with light members (balloon frame) X c. masonry load bearing walls \_\_\_\_\_  
d. metal (explain) \_\_\_\_\_ e. other brick lined

10. CONDITION: excellent X good \_\_\_\_\_ fair \_\_\_\_\_ deteriorated \_\_\_\_\_

11. INTEGRITY: Original site yes If moved, when and from where \_\_\_\_\_  
List major alterations and dates: \_\_\_\_\_

12. ROOF: a. gable \_\_\_\_\_ saltbox \_\_\_\_\_ gambrel \_\_\_\_\_ hip \_\_\_\_\_ mansard \_\_\_\_\_ other \_\_\_\_\_ dormers \_\_\_\_\_  
b. wood shingles \_\_\_\_\_ asphalt shingles X slate \_\_\_\_\_ metal \_\_\_\_\_ other \_\_\_\_\_

14. THREATS TO BUILDING: none known X zoning \_\_\_\_\_ roads \_\_\_\_\_ developers \_\_\_\_\_ deterioration \_\_\_\_\_  
other \_\_\_\_\_

15. RELATED OUTBUILDINGS AND PROPERTY: size of lot 50' x 96' acreage \_\_\_\_\_ barn \_\_\_\_\_  
carriage house \_\_\_\_\_ garage \_\_\_\_\_ privy \_\_\_\_\_ shed \_\_\_\_\_ greenhouse \_\_\_\_\_ shop \_\_\_\_\_ gardens \_\_\_\_\_  
landscape features \_\_\_\_\_ other \_\_\_\_\_

16. SURROUNDINGS OF BUILDING: open land \_\_\_\_\_ woodland \_\_\_\_\_ scattered buildings \_\_\_\_\_ residential X  
densely built-up X commercial \_\_\_\_\_ industrial \_\_\_\_\_ other \_\_\_\_\_

13. MAP

North

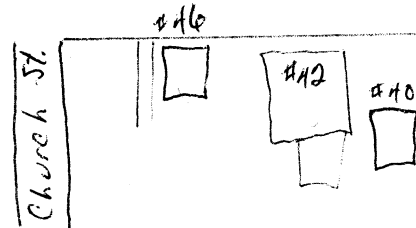

17. INTERRELATIONSHIP OF BUILDING AND SURROUNDINGS:

If structure is in an historic district, name district. \_\_\_\_\_

18. OTHER NOTABLE FEATURES OF THE BUILDING AND SITE: (Include interior features if known)

19. INITIAL CONSTRUCTION:

Date \_\_\_\_\_ Architect \_\_\_\_\_ Builder \_\_\_\_\_

SIGNIFICANT ALTERATIONS:

Date \_\_\_\_\_ Architect \_\_\_\_\_ Builder \_\_\_\_\_

20. ARCHITECTURE: (Indicate period or style if known)

Pre-Revolutionary \_\_\_\_\_ Federal \_\_\_\_\_ Greek Revival \_\_\_\_\_ Victorian \_\_\_\_\_ Other \_\_\_\_\_

20a. HISTORICAL INFORMATION AND TRADITIONS:

21. SOURCES:

Maps: (List name of owner as shown on map and School District where applicable)

1850 Dutchess Co. \_\_\_\_\_ 1858 Dutchess Co. \_\_\_\_\_

1867 Atlas \_\_\_\_\_ School District No. \_\_\_\_\_

1876 Atlas \_\_\_\_\_ School District No. \_\_\_\_\_

\_\_\_\_\_  
\_\_\_\_\_  
\_\_\_\_\_  
\_\_\_\_\_

Location of  
early photographs: \_\_\_\_\_

Inventory by \_\_\_\_\_  
Address \_\_\_\_\_  
\_\_\_\_\_

Date \_\_\_\_\_  
Tel. \_\_\_\_\_



# BUILDING-STRUCTURE INVENTORY FORM

DIVISION FOR HISTORIC PRESERVATION  
NEW YORK STATE PARKS AND RECREATION  
ALBANY, NEW YORK (518) 474-0479

## FOR OFFICE USE ONLY

UNIQUE SITE NO. \_\_\_\_\_  
QUAD \_\_\_\_\_  
SERIES \_\_\_\_\_  
NEG. NO. \_\_\_\_\_

YOUR NAME: Anne R. Wicks DATE: 5/75

YOUR ADDRESS: 60 W Market St. TELEPHONE: 758-6452

ORGANIZATION (if any): Red Hook Landmarks Assoc.

\*\*\*\*\*

### IDENTIFICATION

1. BUILDING NAME(S): \_\_\_\_\_
2. COUNTY: Dutchess TOWN/CITY: Red Hook VILLAGE: Red Hook
3. STREET LOCATION: West Market St.
4. OWNERSHIP: a. public ☐ b. private ☒
5. PRESENT OWNER: Helen A Coon, Search fam. ADDRESS: 46 W Market St.
6. USE: Original: home Present: same
7. ACCESSIBILITY TO PUBLIC: Exterior visible from public road: Yes ☒ No ☐  
Interior accessible: Explain no

### DESCRIPTION

8. BUILDING MATERIAL: a. clapboard ☒ b. stone ☐ c. brick ☐ d. board and batten ☐  
e. cobblestone ☐ f. shingles ☐ g. stucco ☐ other: alum. siding
9. STRUCTURAL SYSTEM: a. wood frame with interlocking joints ☐  
(if known) b. wood frame with light members ☒  
c. masonry load bearing walls ☐  
d. metal (explain) \_\_\_\_\_  
e. other \_\_\_\_\_
10. CONDITION: a. excellent ☒ b. good ☐ c. fair ☐ d. deteriorated ☐
11. INTEGRITY: a. original site ☒ b. moved ☐ if so, when? \_\_\_\_\_  
c. list major alterations and dates (if known): kitchen & bedroom added  
date unknown

12. PHOTO:

13. MAP:



14. THREATS TO BUILDING: a. none known ☒ b. zoning ☐ c. roads ☐  
d. developers ☐ e. deterioration ☐  
f. other: \_\_\_\_\_
15. RELATED OUTBUILDINGS AND PROPERTY:  
a. barn ☐ b. carriage house ☐ c. garage ☐  
d. privy ☐ e. shed ☐ f. greenhouse ☐  
g. shop ☐ h. gardens ☐  
i. landscape features: \_\_\_\_\_  
j. other: \_\_\_\_\_
16. SURROUNDINGS OF THE BUILDING (check more than one if necessary):  
a. open land ☐ b. woodland ☐  
c. scattered buildings ☐  
d. densely built-up ☒ e. commercial ☐  
f. industrial ☐ g. residential ☒  
h. other: \_\_\_\_\_
17. INTERRELATIONSHIP OF BUILDING AND SURROUNDINGS:  
(Indicate if building or structure is in an historic district)
18. OTHER NOTABLE FEATURES OF BUILDING AND SITE (including interior features if known):

**SIGNIFICANCE**

19. DATE OF INITIAL CONSTRUCTION: \_\_\_\_\_  
ARCHITECT: \_\_\_\_\_  
BUILDER: \_\_\_\_\_
20. HISTORICAL AND ARCHITECTURAL IMPORTANCE:
21. SOURCES:
22. THEME: