

# LANDMARKS

Dutchess County Landmarks Association, Inc.  
P.O. Box 944, Poughkeepsie, New York 12602

## BUILDING - STRUCTURE INVENTORY FORM

TOWNSHIP \_\_\_\_\_ Code \_\_\_\_\_  
or CITY \_\_\_\_\_ No. \_\_\_\_\_

1. BUILDING NAME \_\_\_\_\_

2. VILLAGE or HAMLET \_\_\_\_\_

3. STREET or ROAD \_\_\_\_\_

4. OWNERSHIP: Public \_\_\_\_\_ Private ☒

5a. PRESENT OWNER Betty Jo & George Tabor

metzger Rhinebeck, New York  
Mailing Address \_\_\_\_\_

Deed Recorded: Liber \_\_\_\_\_ Page \_\_\_\_\_

5b. PRESENT OCCUPANT Mrs. Lottie Kittner

Renter 23 Church St.  
Mailing Address Red Hook, N. York.

5c. FORMER OWNERS  
Name \_\_\_\_\_ Dates of Ownership \_\_\_\_\_

Data on back

13. MAP

North

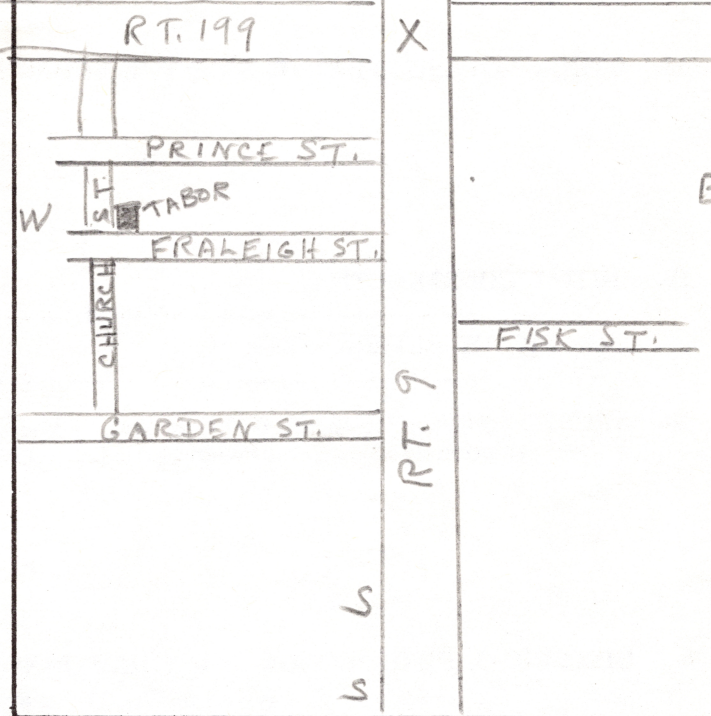

6. USES  
Present House

is rented

7. ACCESSIBILITY TO PUBLIC: Exterior visible from public road: Yes ☒ No \_\_\_\_\_  
Interior accessible: Explain Private dwelling

8. BUILDING MATERIAL: clapboard ☒ stone storm cellar brick \_\_\_\_\_  
board and batten \_\_\_\_\_ shingles \_\_\_\_\_ stucco \_\_\_\_\_ other \_\_\_\_\_

9. STRUCTURAL SYSTEM: a. wood frame with interlocking joints (post and beam) ☒  
b. wood frame with light members (balloon frame) \_\_\_\_\_ c. masonry load bearing walls \_\_\_\_\_  
d. metal (explain) \_\_\_\_\_ e. other \_\_\_\_\_

10. CONDITION: excellent \_\_\_\_\_ good ☒ fair \_\_\_\_\_ deteriorated \_\_\_\_\_

11. INTEGRITY: Original site ☒ If moved, when and from where \_\_\_\_\_  
List major alterations and dates: \_\_\_\_\_

12. ROOF: a. gable \_\_\_\_\_ saltbox \_\_\_\_\_ gambrel \_\_\_\_\_ hip \_\_\_\_\_ mansard \_\_\_\_\_ other \_\_\_\_\_ dormers \_\_\_\_\_  
b. wood shingles \_\_\_\_\_ asphalt shingles ☒ slate \_\_\_\_\_ metal \_\_\_\_\_ other \_\_\_\_\_

14. THREATS TO BUILDING: none known ☒ zoning \_\_\_\_\_ roads \_\_\_\_\_ developers \_\_\_\_\_ deterioration \_\_\_\_\_  
other \_\_\_\_\_

15. RELATED OUTBUILDINGS AND PROPERTY: size of lot \_\_\_\_\_ acreage 1/4 acre barn \_\_\_\_\_  
carriage house \_\_\_\_\_ garage \_\_\_\_\_ privy \_\_\_\_\_ shed \_\_\_\_\_ greenhouse \_\_\_\_\_ shop \_\_\_\_\_ gardens \_\_\_\_\_  
landscape features \_\_\_\_\_ other \_\_\_\_\_

16. SURROUNDINGS OF BUILDING: open land \_\_\_\_\_ woodland \_\_\_\_\_ scattered buildings \_\_\_\_\_ residential ☒  
densely built-up \_\_\_\_\_ commercial \_\_\_\_\_ industrial \_\_\_\_\_ other \_\_\_\_\_

(over)



17. INTERRELATIONSHIP OF BUILDING AND SURROUNDINGS:

If structure is in an historic district, name district. \_\_\_\_\_

18. OTHER NOTABLE FEATURES OF THE BUILDING AND SITE: (Include interior features if known)

19. INITIAL CONSTRUCTION:

Date \_\_\_\_\_ Architect \_\_\_\_\_ Builder \_\_\_\_\_

SIGNIFICANT ALTERATIONS:

Date \_\_\_\_\_ Architect \_\_\_\_\_ Builder \_\_\_\_\_

20. ARCHITECTURE: (Indicate period or style if known)

Pre-Revolutionary \_\_\_\_\_ Federal \_\_\_\_\_ Greek Revival \_\_\_\_\_ Victorian \_\_\_\_\_ Other ☒

20a. HISTORICAL INFORMATION AND TRADITIONS:

Ida & George Williams sold house to  
Anna & William Massonneau in 1914  
Massonneau sold house to  
Francis Lown in 1921  
Lown sold house to Joseph &  
Julia Mahrer & Nancy &  
Edward O'Connell in 1928  
They (Mahrer & O'Connell) sold  
house to Harold & Florence Coone in 1930  
Betty Jo & George Tabor bought house  
from the Coone Estate in 1972

21. SOURCES:

Maps: (List name of owner as shown on map and School District where applicable)

1850 Dutchess Co. \_\_\_\_\_ 1858 Dutchess Co. \_\_\_\_\_

1867 Atlas \_\_\_\_\_ School District No. \_\_\_\_\_

1876 Atlas ☒ ? \_\_\_\_\_ School District No. \_\_\_\_\_

*Mrs. Tabor looked up deeds & gave me the  
above information*

Location of  
early photographs: \_\_\_\_\_

Inventory by

Address

*Edythe Budd*  
*P.O. B. 143*  
*Red Hook, N.York.*

Date

Tel.

*May 15, 1975*



# BUILDING-STRUCTURE INVENTORY FORM

DIVISION FOR HISTORIC PRESERVATION  
NEW YORK STATE PARKS AND RECREATION  
ALBANY, NEW YORK (518) 474-0479

## FOR OFFICE USE ONLY

UNIQUE SITE NO. \_\_\_\_\_  
QUAD \_\_\_\_\_  
SERIES \_\_\_\_\_  
NEG. NO. \_\_\_\_\_

YOUR NAME: Mr. Eugene E. Budd DATE: May 15, 1975

YOUR ADDRESS: P.O. B143 TELEPHONE: PL 8-8090  
Red Hook, N.Y.

ORGANIZATION (if any): \_\_\_\_\_

\*\*\*\*\*

## IDENTIFICATION

1. BUILDING NAME(S): \_\_\_\_\_
2. COUNTY: Dutchess TOWN/CITY: \_\_\_\_\_ VILLAGE: Red Hook
3. STREET LOCATION: 23 Church St
4. OWNERSHIP: a. public ☐ b. private ☒
5. PRESENT OWNER: George Tabor ADDRESS: \_\_\_\_\_
6. USE: Original: Residential Present: Residential
7. ACCESSIBILITY TO PUBLIC: Exterior visible from public road: Yes ☒ No ☐  
Interior accessible: Explain No - Private Dwelling

## DESCRIPTION

8. BUILDING MATERIAL: a. clapboard ☒ b. stone ☐ c. brick ☐ d. board and batten ☐  
e. cobblestone ☐ f. shingles ☐ g. stucco ☐ other: \_\_\_\_\_
9. STRUCTURAL SYSTEM: a. wood frame with interlocking joints ☒  
(if known) b. wood frame with light members ☐  
c. masonry load bearing walls ☐  
d. metal (explain) \_\_\_\_\_  
e. other \_\_\_\_\_
10. CONDITION: a. excellent ☐ b. good ☒ c. fair ☐ d. deteriorated ☐
11. INTEGRITY: a. original site ☐ b. moved ☐ if so, when? \_\_\_\_\_  
c. list major alterations and dates (if known): \_\_\_\_\_

12. PHOTO:

13. MAP:

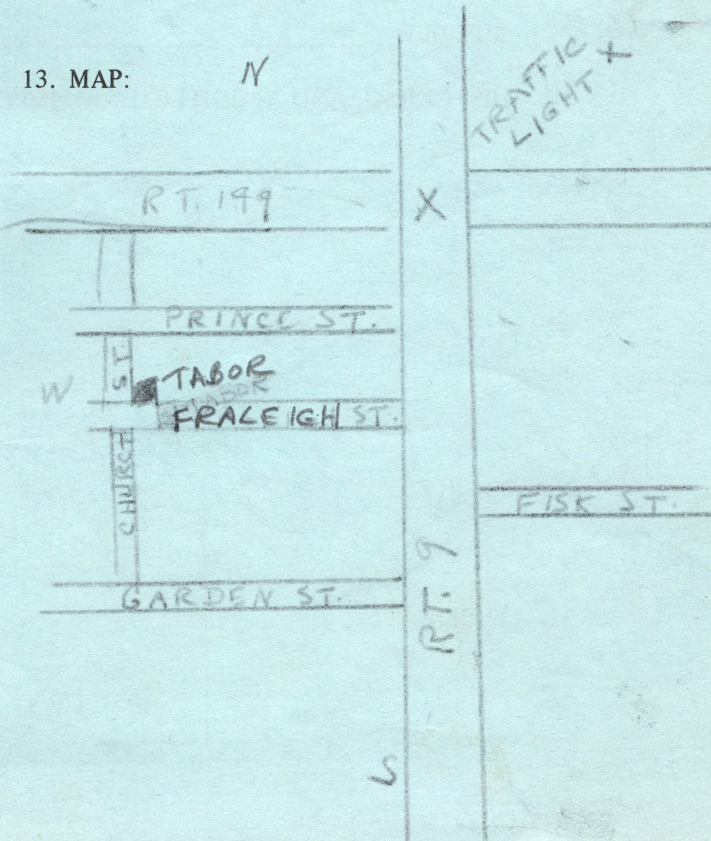



14. THREATS TO BUILDING: a. none known ☒ b. zoning ☐ c. roads ☐  
d. developers ☐ e. deterioration ☐  
f. other: \_\_\_\_\_
15. RELATED OUTBUILDINGS AND PROPERTY:  
a. barn ☐ b. carriage house ☐ c. garage ☐  
d. privy ☐ e. shed ☐ f. greenhouse ☐  
g. shop ☐ h. gardens ☐  
i. landscape features: \_\_\_\_\_  
j. other: \_\_\_\_\_
16. SURROUNDINGS OF THE BUILDING (check more than one if necessary):  
a. open land ☐ b. woodland ☐  
c. scattered buildings ☐  
d. densely built-up ☐ e. commercial ☐  
f. industrial ☐ g. residential ☒  
h. other: \_\_\_\_\_
17. INTERRELATIONSHIP OF BUILDING AND SURROUNDINGS:  
(Indicate if building or structure is in an historic district)
18. OTHER NOTABLE FEATURES OF BUILDING AND SITE (including interior features if known):

**SIGNIFICANCE**

19. DATE OF INITIAL CONSTRUCTION: \_\_\_\_\_

ARCHITECT: \_\_\_\_\_

BUILDER: \_\_\_\_\_

20. HISTORICAL AND ARCHITECTURAL IMPORTANCE:

21. SOURCES:

*Seeds belonging to present owner.*

22. THEME: